



DEE TEE MATRIX



for all your Automation Need



DEE TEE MATRIX



ALUMINIUM PROFILES

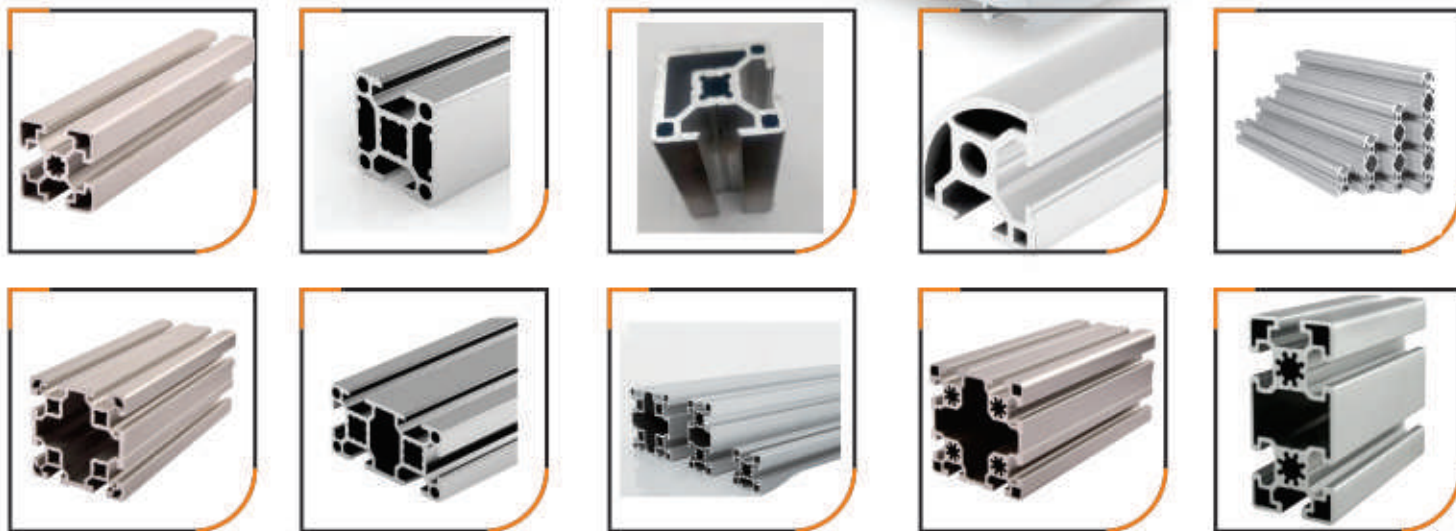

CONNECTING ELEMENTS

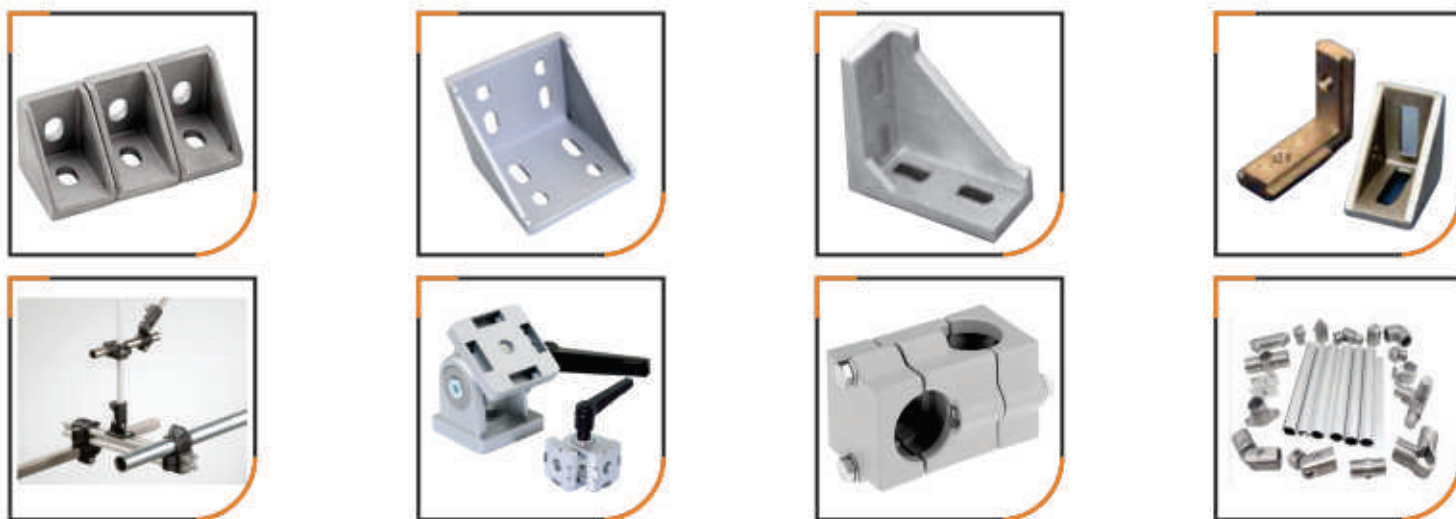

FASTENERS





DEE TEE MATRIX



HINGES & HANDLES



ACCESSORIES



LEVELLING FOOT & CASTORS



SOP DISPLAY

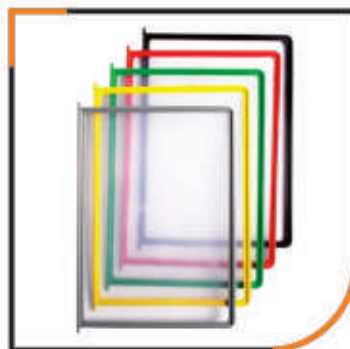
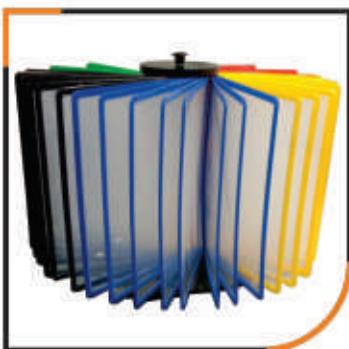



DEE TEE MATRIX

ALUMINIUM PROFILE SYSTEM

WORK STATION



INSPECTION TABLE



ASSEMBLY STATION



ENCLOSURE



STRUCTURAL ASSEMBLY



ROBOT FENCING



FIFO RACK



INSPECTION TABLE (PIPE STRUCTURE)



TROLLEY



ROLLER CONVEYOR



BELT CONVEYOR



MODULAR CONVEYOR



Admin. Office :
2/202-A1, Devi Illam, Mylapatti, Coimbatore - 641 062
☎ 99944 77071 / 94421 15571
✉ deeteematrix@gmail.com

Works :
SF. No. 50/1, Site No. 8A, Serayampalayam Road,
Neelambur, Coimbatore - 641 062
Tamilnadu, India

Contents

Hammer Nuts.....	P1-2
T bolt.....	P3-4
Mushroom Bolt.....	P5
Elastic Fastener.....	P6-7
Slide Block.....	P8-9
T-nut with spring ball.....	P10-11
T-nut with spring leafv.....	P12-13
Profile Connector.....	P14
Inner Bracket.....	P15-17
Inner Connector.....	P18-19
L bracket.....	P20-23
Steering Corner Bracket.....	P24-25
45 Degree Corner Bracket.....	P26
90 Degree Angle Bracket.....	P27
Interval Block.....	P28-29
Cover.....	P30-33
Plastic Hinge.....	P34-35
Zinc Hinge.....	P35-37
T Slot Bar.....	P38

Interior Connector Whistle.....	P39-40
Handle.....	P41
Profile Hanger.....	P42
3-WayCorner Connector.....	P43
2-Way Corner Connector.....	P44
Concealed 3-way Corner Bracket.....	P45
3-Way Corner Bracket.....	P45
Steering Connecting Plate.....	P46
Cross Joining Plate.....	P47-48
Aluminum Base Plate.....	P49
Flange Nuts.....	P50
Washers.....	P51
Socket Head Cap Screw.....	P52
Button Head Cap Screw.....	P53
Flat Head Socket Screwv.....	P54
Adjustable Leveling Foot.....	P55
Fixed Leveling Foot.....	P56
TSlot Tread Strip.....	P57
Eye Bolt.....	P57
Leveling Caster.....	P58-62

Hammer Nuts

Material : Carbon Steel / Stainless Steel
 Surface treatment : Zinc / Nickel Plated

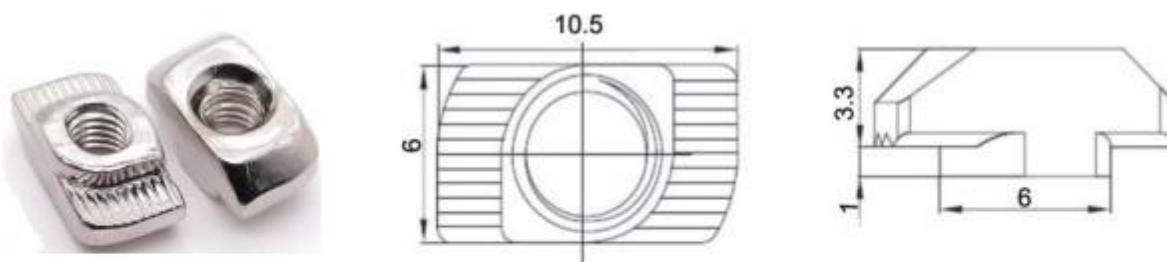

Description	Dia	Mass/g	Part No
6-M3	M3	1.5	16203
6-M4	M4	1.3	16204
6-M5	M5	1	16205

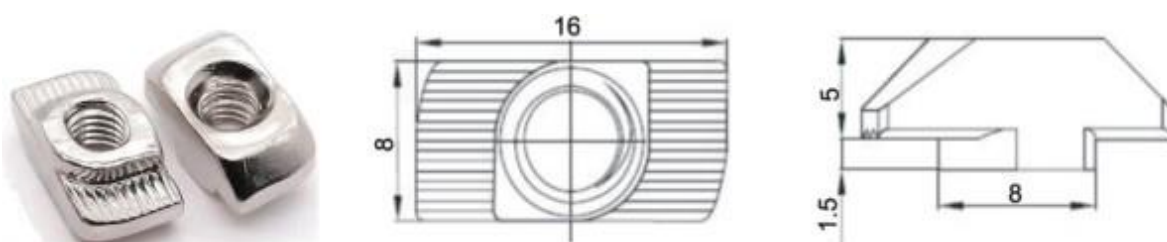

Description	Dia	Mass/g	Part No
8-M3	M3	3.8	16303
8-M4	M4	3.6	16304
8-M5	M5	3.5	16305
8-M6	M6	3.2	16306

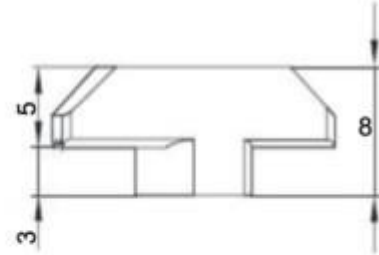
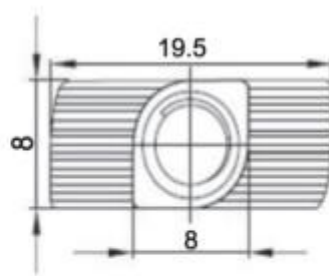

Description	Dia	Mass/g	Part No
8-M4	M4	5.5	16404
8-M5	M5	5.2	16405
8-M6	M6	4.6	16406

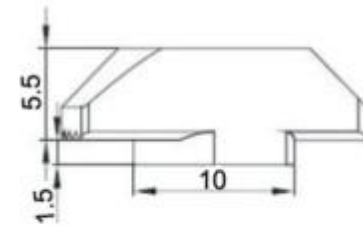
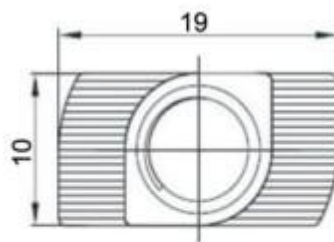

Description	Dia	Mass/g	Part No
8-M8	M8	5.5	16408

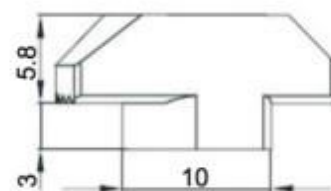
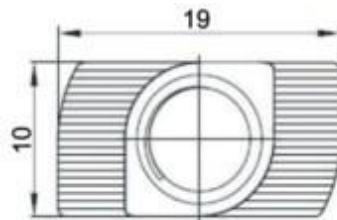

Description	Dia	Mass/g	Part No
10-M4	M4	8.3	16454
10-M5	M5	7.8	16455
10-M6	M6	7.3	16456
10-M8	M8	7.1	16458

T Bolts

T BOLT

Material : Carbon steel

Surface treatment: Zinc / nickel plated

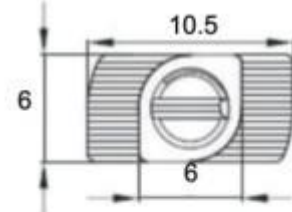
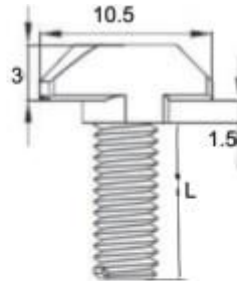

Description	L	Mass/g	Part No
M5×10-20	10	2.9	20106
M5×12-20	12	3.4	20126
M5×16-20	16	3.9	20166
M5×20-20	20	4.3	20206

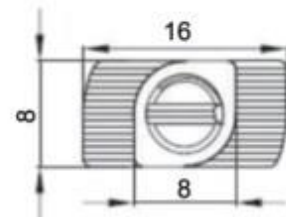
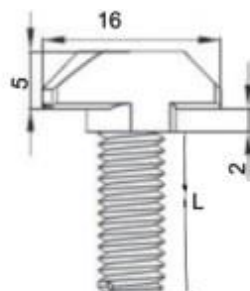

Description	L	Mass/g	Part No
M6×12-30	12	6.3	22212
M6×16-30	16	7.1	22216
M6×20-30	20	7.8	22220
M6×25-30	25	8.6	22225

T Bolts

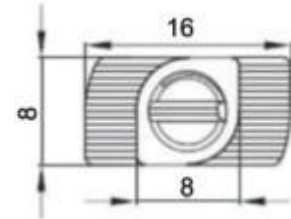
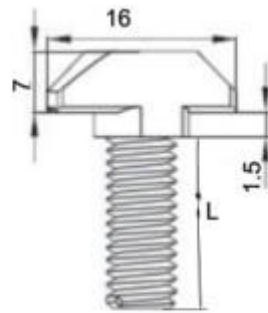

Description	L	Mass/g	Part No
M8×16-30	16	9.6	22316
M8×20-30	20	10.7	22320
M8×25-30	25	11.5	22325

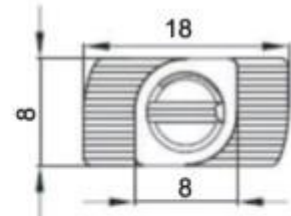
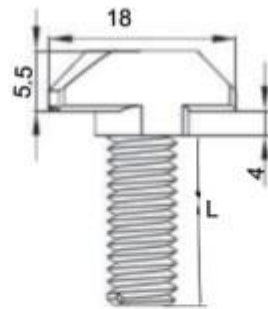

Description	L	Mass/g	Part No
M8×16-40	16	10.3	22416
M8×20-40	20	11.7	22420
M8×25-40	25	13.3	22425
M8×30-40	30	14.7	22430
M8×35-40	35	16.4	22435
M8×40-40	40	17.8	22440

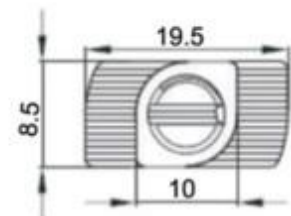
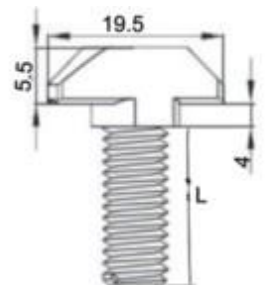

Description	L	Mass/g	Part No
M8×20-45	20	13.2	22520
M8×25-45	25	14.6	22525
M8×30-45	30	16.1	22530
M8×35-45	35	17.4	22535
M8×40-45	40	19.1	22540
M8×45-45	45	20.7	22545

Mushroom Bolt

Mushroom Bolt

Material : Zinc-plated Carbon Steel

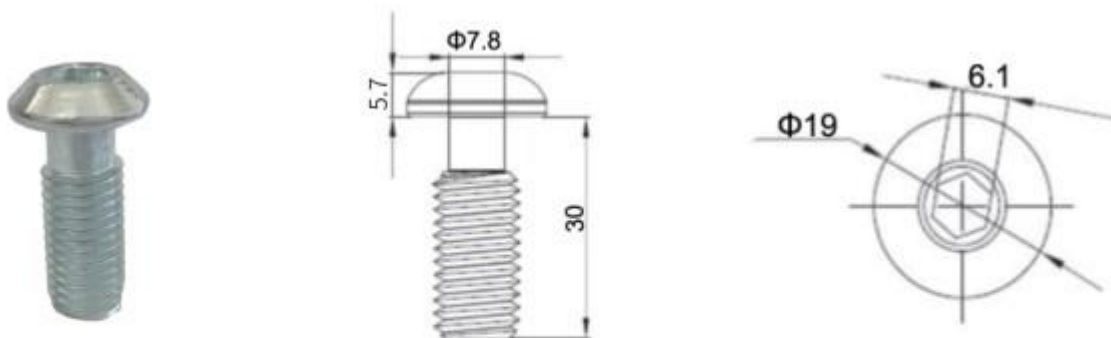

Description	Dia	Mass/g	Part No
M12×30-8	M12	27.2	23008

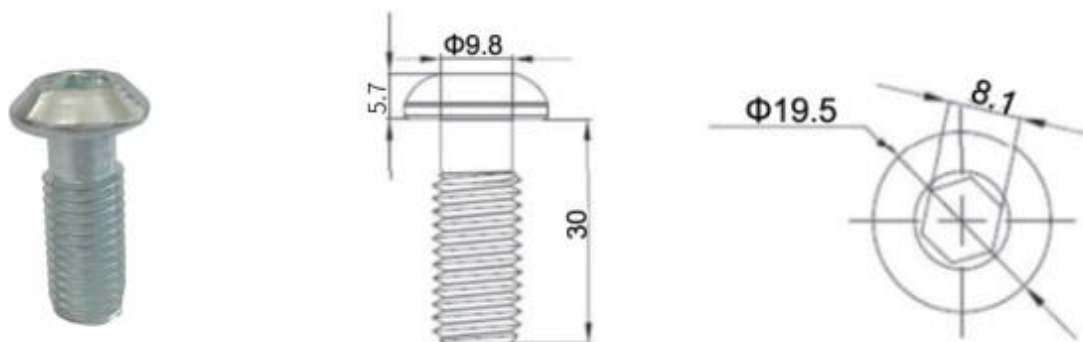

Description	Dia	Mass/g	Part No
M12×30-10	M12	27.2	23009

Elastic Fastener

Elastic Fastener

Material: steel

Surface treatment : Zinc / nickel plated

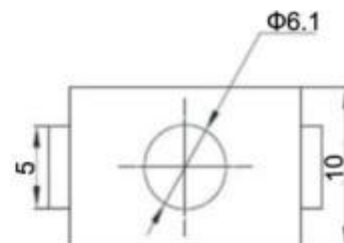
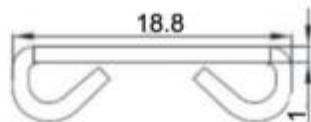

Description	Dia	Mass/g	Part No
2020	M6	4.2	20201

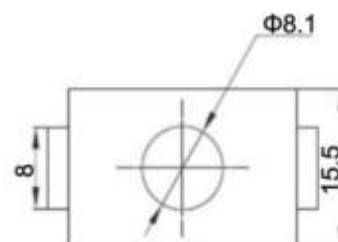
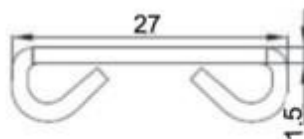

Description	Dia	Mass/g	Part No
3030	M8	5.9	30301

Elastic Fastener

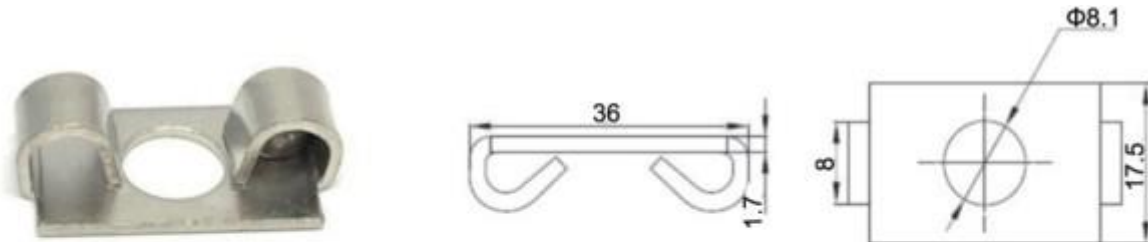

Description	Dia	Mass/g	Part No
4040	M8	11	40401

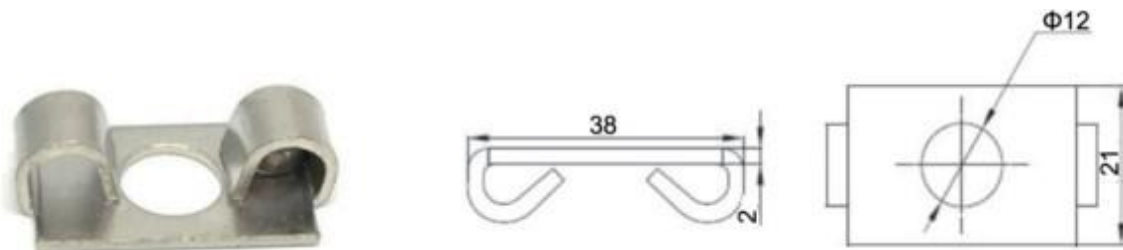

Description	Dia	Mass/g	Part No
4545	M12	14.5	45451

Slide Block

Slide Block

Material: Carbon Steel / Stainless Steel

Surface treatment : Zinc / nickel

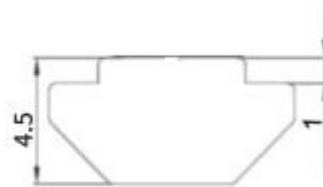
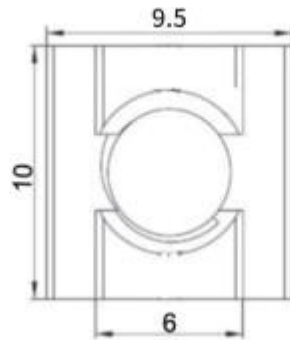

Description	Dia	Mass/g	Part No
6-M4	M4	2.8	28204
6-M5	M5	2.2	28205
6-M6	M6	1.9	28206

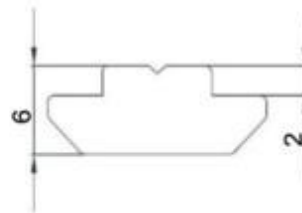
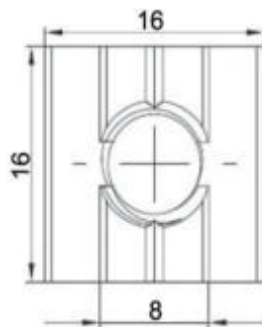

Description	Dia	Mass/g	Part No
8-M4	M4	8.5	28304
8-M5	M5	8.3	28305
8-M6	M6	7.8	28306
8-M8	M8	6.7	28308

Slide Block

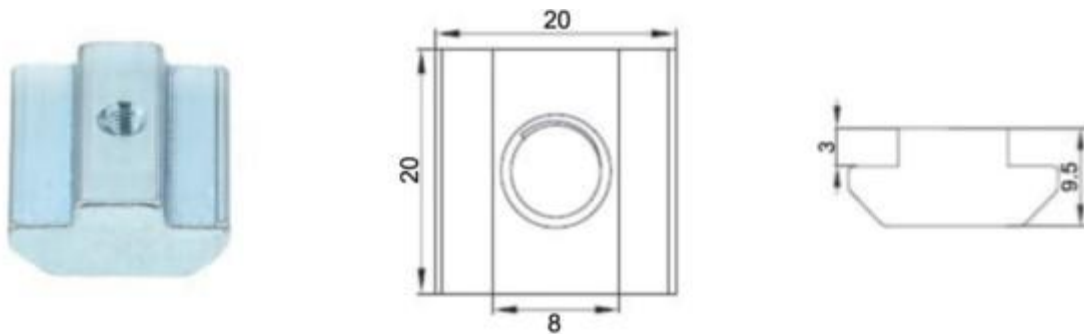

Description	Dia	Mass/g	Part No
8-M4	M4	21.2	28404
8-M5	M5	20.6	28405
8-M6	M6	18.7	28406
8-M8	M8	16.6	28408

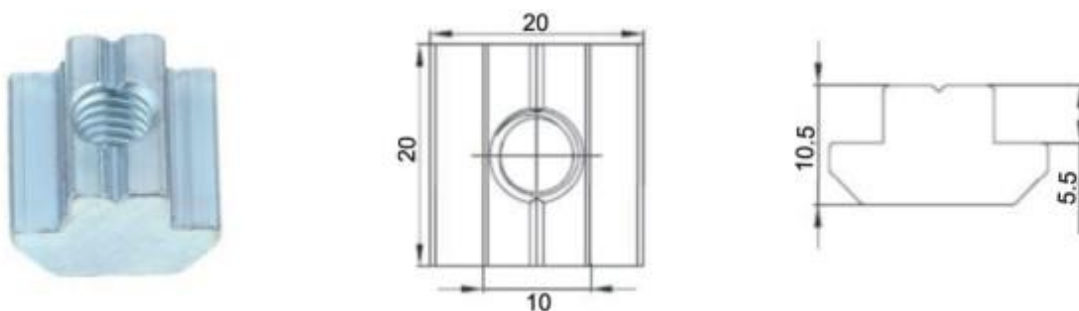

Description	Dia	Mass/g	Part No
10-M4	M4	21.3	28454
10-M5	M5	20.6	28455
10-M6	M6	20	28456
10-M8	M8	18.4	28458
10-M10	M10	17.9	28451

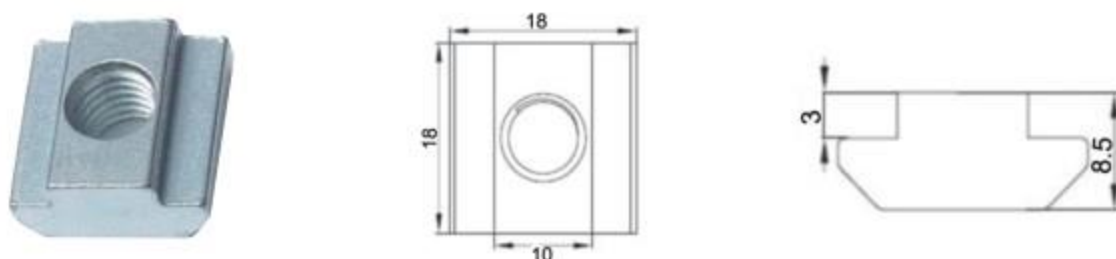

Description	Dia	Mass/g	Part No
10-M4	M4	21.3	28104
10-M5	M5	20.6	28105
10-M6	M6	18.7	28106
10-M8	M8	18.4	28108

Slide Block

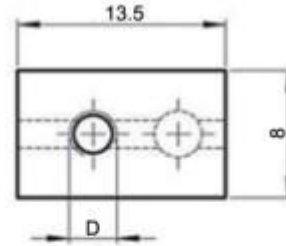
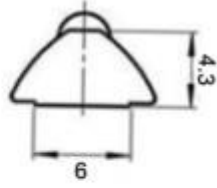

Description	Dia	Mass/g	Part No
6-M4	M4	2.2	27204
6-M5	M5	2	27205
6-M6	M6	1.6	27206

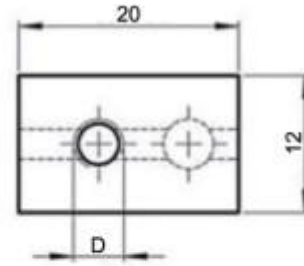
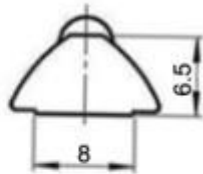

Description	Dia	Mass/g	Part No
8-M4	M4	8	27304
8-M5	M5	7.7	27305
8-M6	M6	7.2	27306
8-M8	M8	6.5	27308

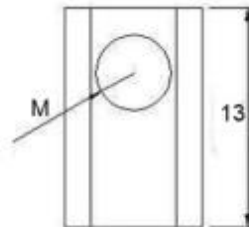
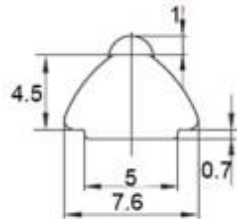

Description	Dia	Mass/g	Part No
5-M3	M3	2.3	27253
5-M4	M4	2.1	27254
5-M5	M5	2	27255

T-Nut with spring ball

T-Nut with spring ball

Material: Carbon Steel

Surface treatment : Zinc / nickel plated

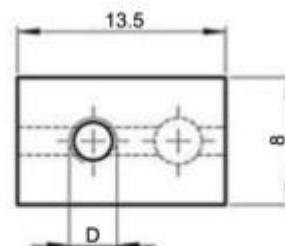
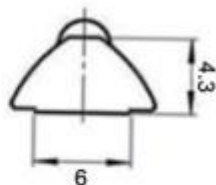

Description	Dia	Mass/g	Part No
6-M4	M4	2.2	27204
6-M5	M5	2	27205
6-M6	M6	1.6	27206

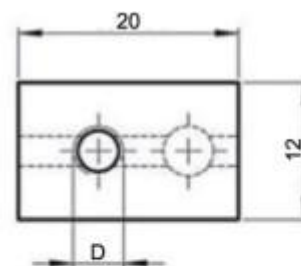
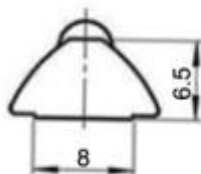

Description	Dia	Mass/g	Part No
8-M4	M4	8	27304
8-M5	M5	7.7	27305
8-M6	M6	7.2	27306
8-M8	M8	6.5	27308

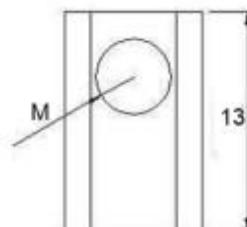
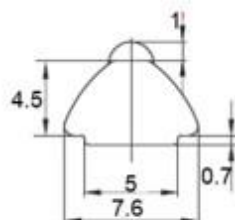

Description	Dia	Mass/g	Part No
5-M3	M3	2.3	27253
5-M4	M4	2.1	27254
5-M5	M5	2	27255

T-Nut with spring ball

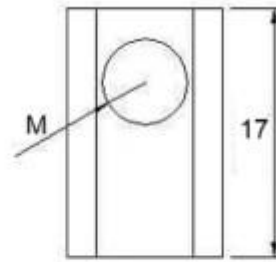
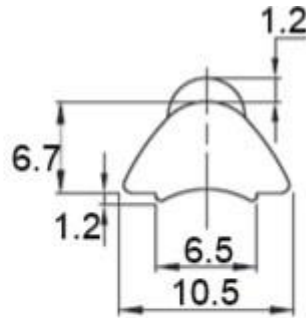

Description	Dia	Mass/g	Part No
6-M4	M4	5.3	27264
6-M5	M5	4.9	27265
6-M6	M6	4.8	27266

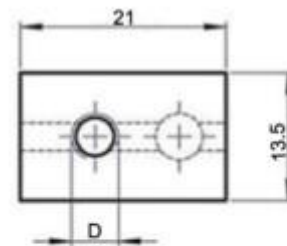
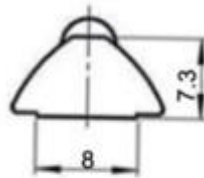

Description	Dia	Mass/g	Part No
8-M4	M4	11.3	27404
8-M5	M5	11	27405
8-M6	M6	10.8	27406
8-M8	M8	9.5	27408

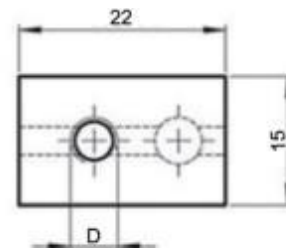
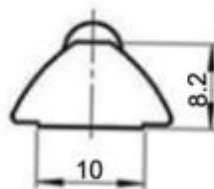

Description	Dia	Mass/g	Part No
10-M4	M4	15.2	27454
10-M5	M5	14.7	27455
10-M6	M6	13.9	27456
10-M8	M8	13.4	27458

L Bracket

L Bracket

Material: Alu-alloy

Color: Silver / Black

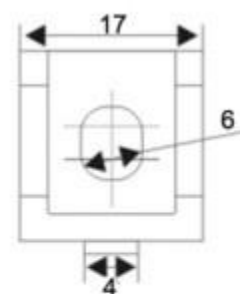
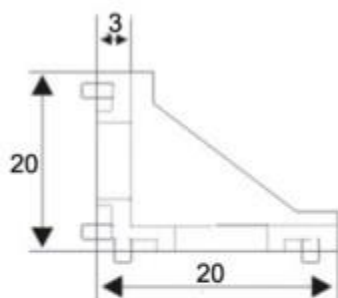

Size	Mass/g	Part No
2017	5.5	72017

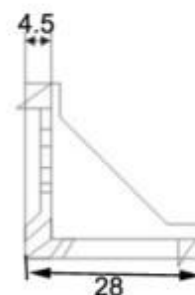
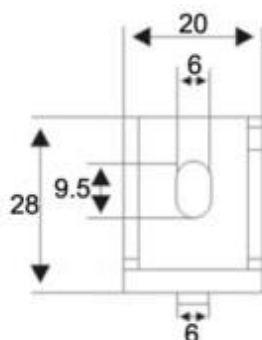

Size	Mass/g	Part No
2020	14	72020

L Bracket

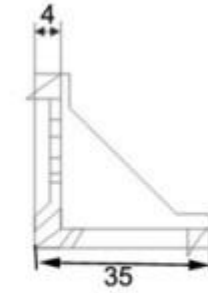
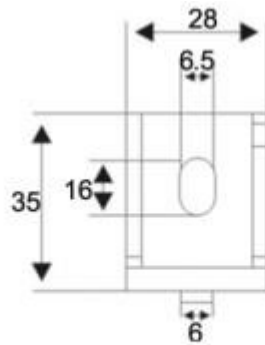

Size	Mass/g	Part No
3030	28.3	73030

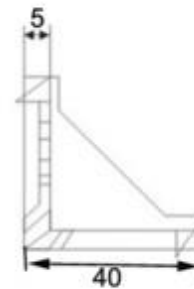
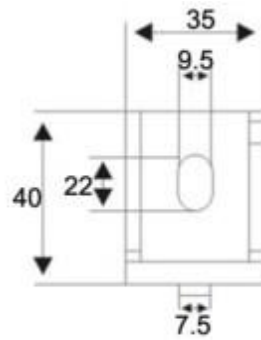

Size	Mass/g	Part No
4040	28.4	74040

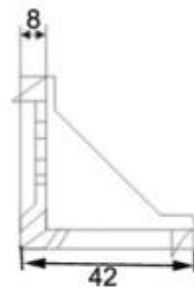

Size	Mass/g	Part No
4545	46	74575

Inner Connector

Inner Connector

Material: carbon steel

Surface treatment : Zinc plated

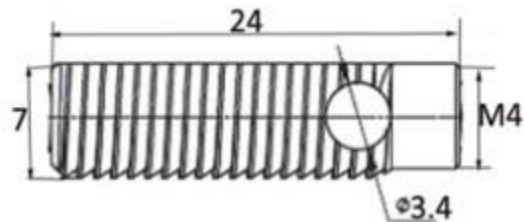

Size	Mass/g	Part No
2020	3	20203

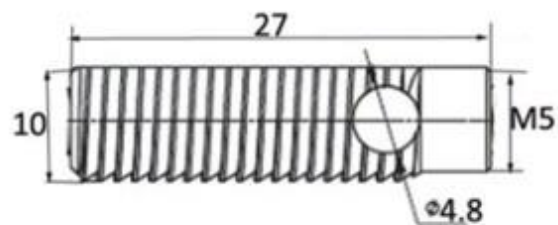

Size	Mass/g	Part No
3030	8.5	30303

Profile Connector

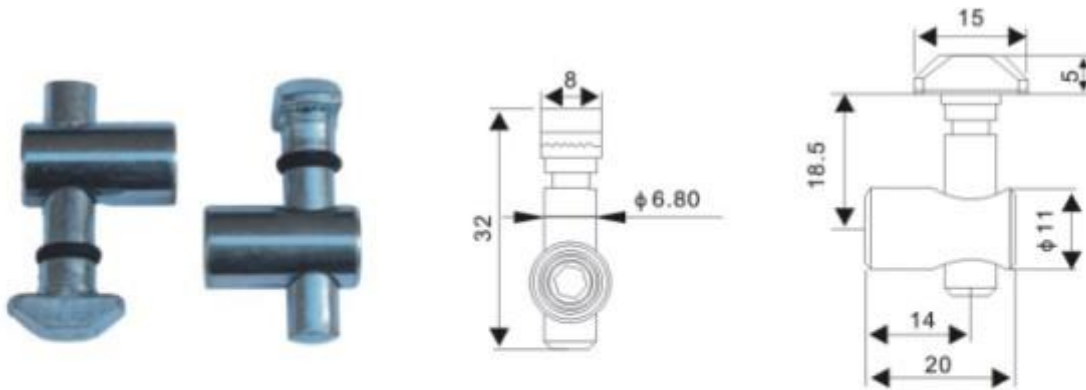

Size	Mass/g	Part No
30-0	20.5	30800

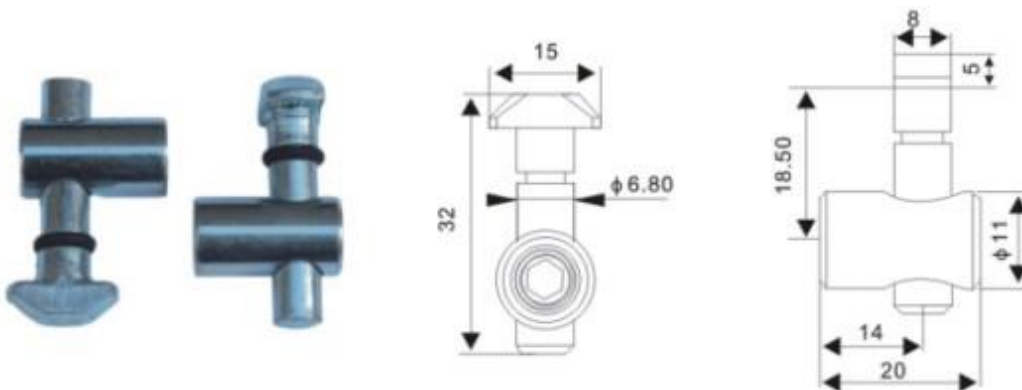

Size	Mass/g	Part No
30-90	20.5	30890

Profile Connector

Profile Connector

Material: carbon steel

Surface treatment : Zinc plated

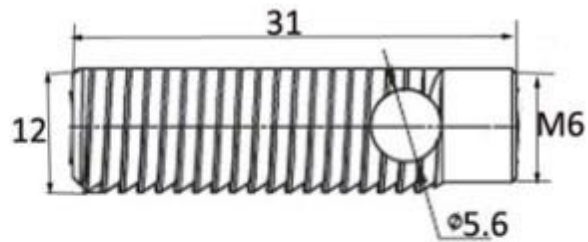

Size	Mass/g	Part No
4040	14	40403

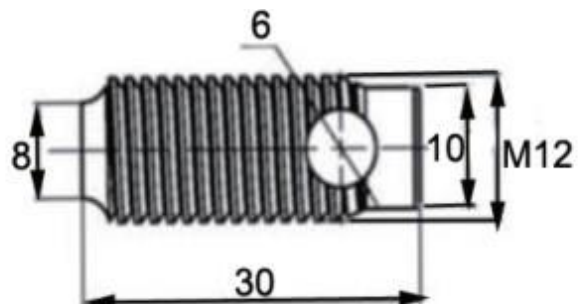

Size	Mass/g	Part No
4045	12.8	45453

Inner Bracket

Inner Bracket

Material: Zinc alloy

Surface treatment : nickel

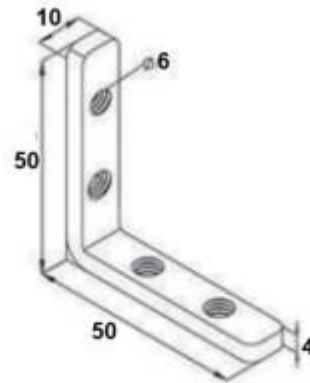

Size	Mass/g	Part No
1515	19.9	15152

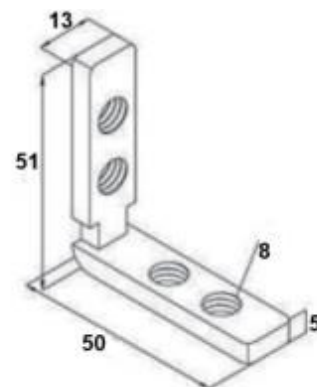

Size	Mass/g	Part No
2040	22	20402

Inner Bracket

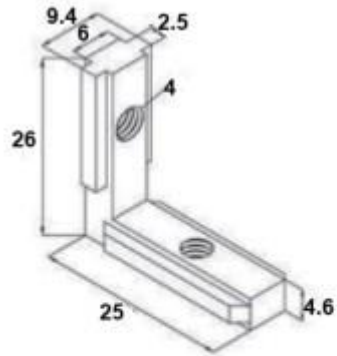

Size	Mass/g	Part No
2020	9.5	20202

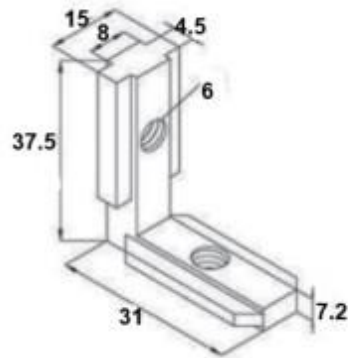

Size	Mass/g	Part No
3030	28	30302

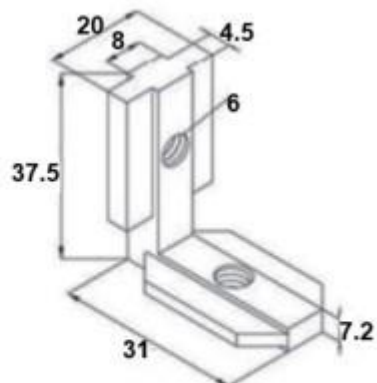

Size	Mass/g	Part No
4040	32	40402

Inner Bracket

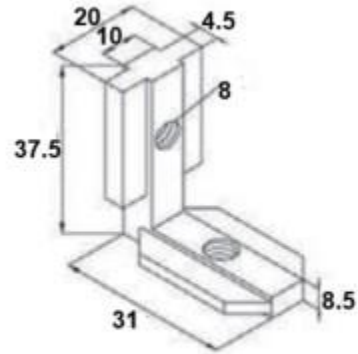

Size	Mass/g	Part No
4545	41	45452

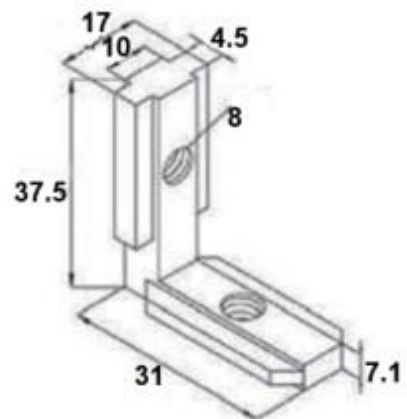

Size	Mass/g	Part No
4545	35	45412

Inner Connector

Inner Connector

Material : carbon steel

Surface treatment : Zinc plated

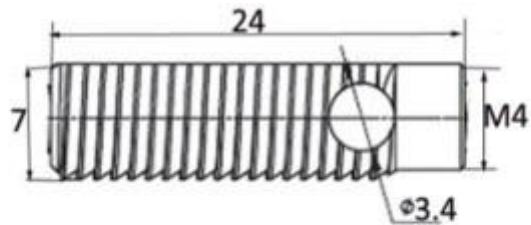

Size	Mass/g	Part No
2020	3	20203

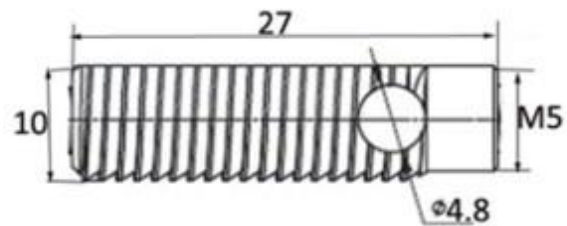

Size	Mass/g	Part No
3030	8.5	30303

Inner Connector

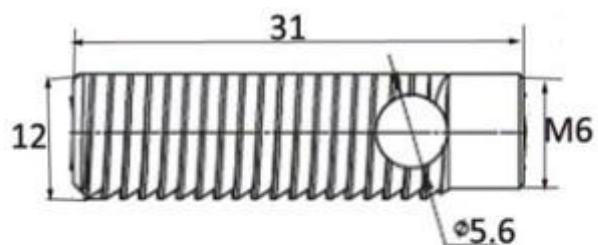

Size	Mass/g	Part No
4040	14	40403

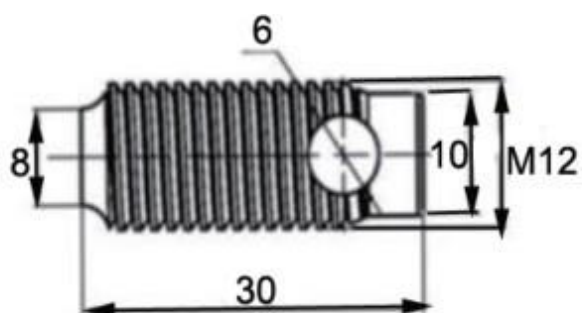

Size	Mass/g	Part No
4045	12.8	45453

L Bracket

L Bracket

Material: Alu-alloy

Color : Silver / Black

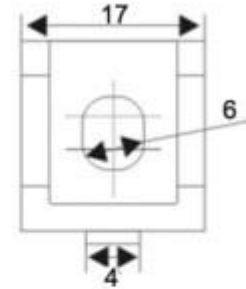
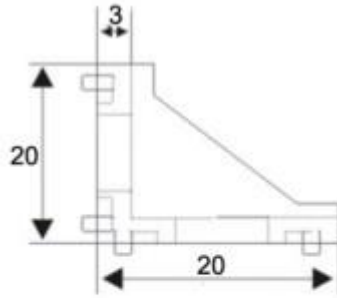

Size	Mass/g	Part No
2017	5.5	72017

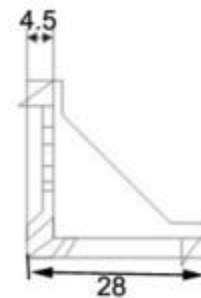

Size	Mass/g	Part No
2020	14	72020

L Bracket

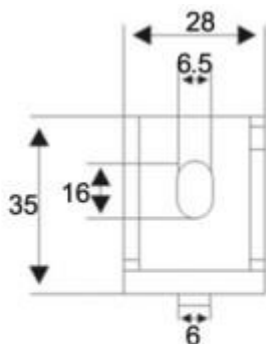

Size	Mass/g	Part No
3030	28.3	73030

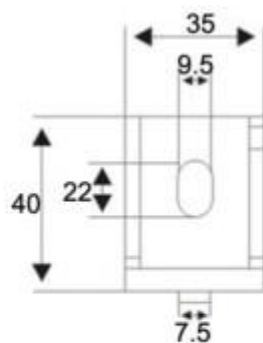

Size	Mass/g	Part No
4040	28.4	74040

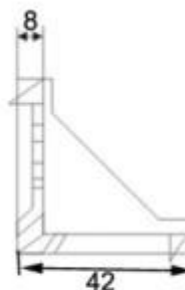

Size	Mass/g	Part No
4545	46	74575

L Bracket

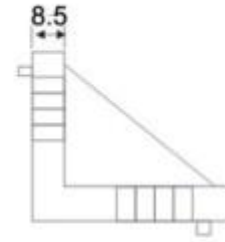
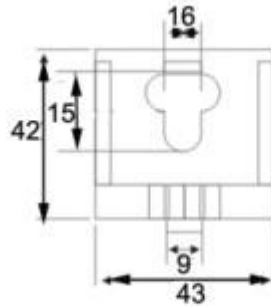

Size	Mass/g	Part No
4545	47	74541

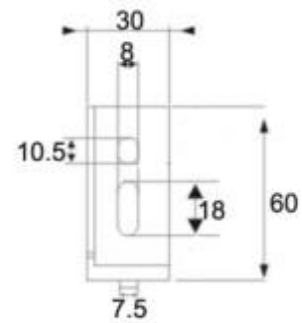

Size	Mass/g	Part No
3060	44	73060

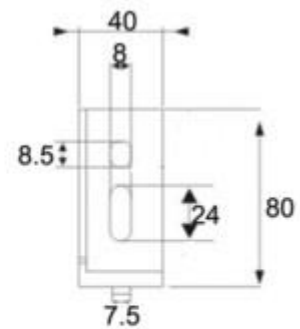

Size	Mass/g	Part No
4080	75	74080

L Bracket

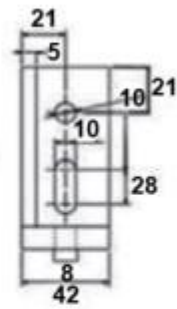
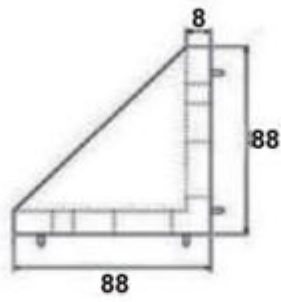

Size	Mass/g	Part No
4090	75	74090

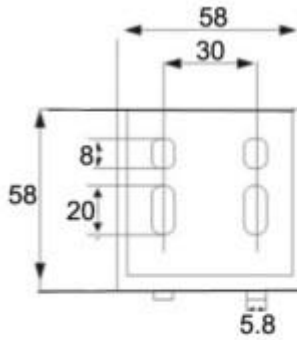

Size	Mass/g	Part No
6060	75	76060

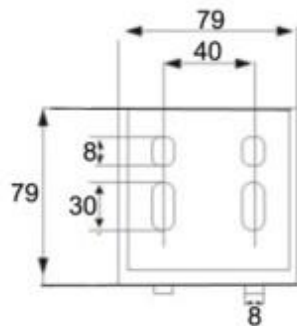

Size	Mass/g	Part No
8080	167	78080

Steering Corner Bracket

Steering Corner Bracket
Material: Alu-alloy
Color : Silver

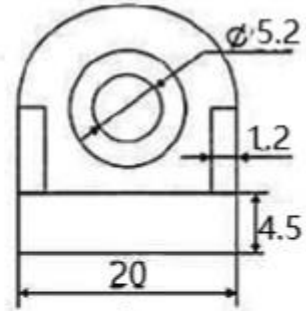
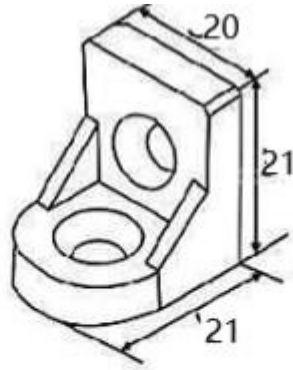

Size	Mass/g	Part No
2020	14.5	71020

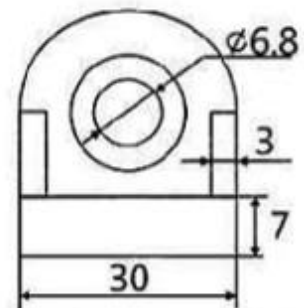
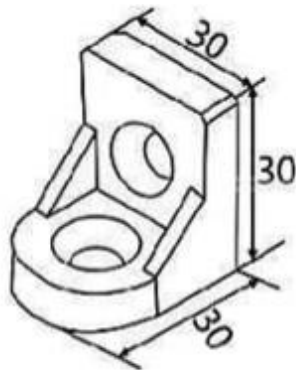

Size	Mass/g	Part No
3030	24	71030

Steering Corner Bracket

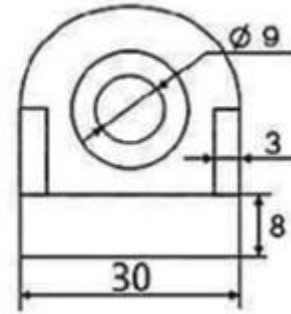
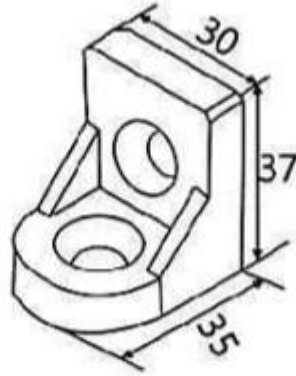

Size	Mass/g	Part No
4040	24.6	71040

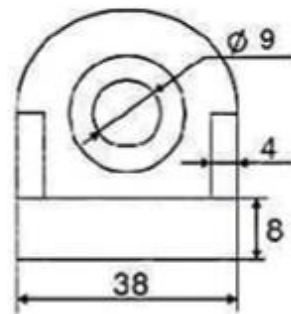
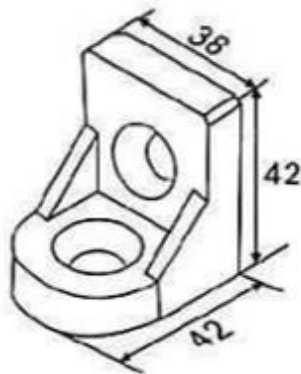

Size	Mass/g	Part No
4545	38.9	71045

Interval Block

Interval Block
Material: Plastic
Color : Silver / Black

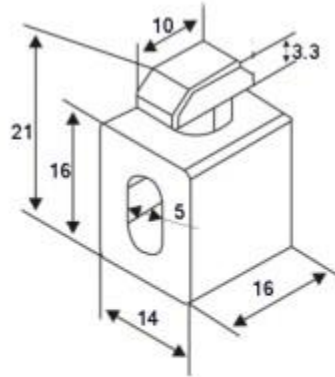

Size	Mass/g	Part No
2020	6.8	20204

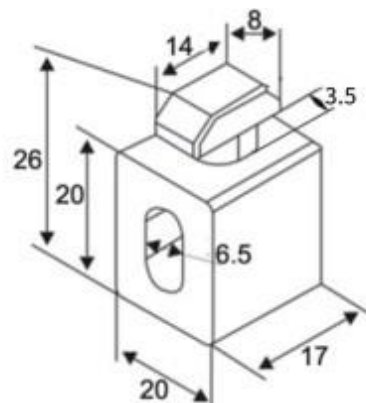

Size	Mass/g	Part No
3030	7.4	30304

Interval Block

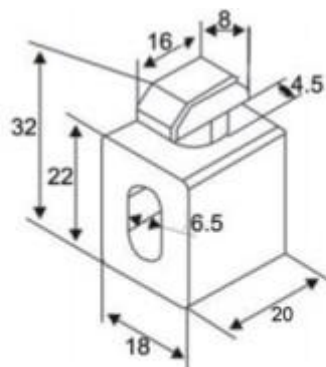

Size	Mass/g	Part No
4040	10.7	40404

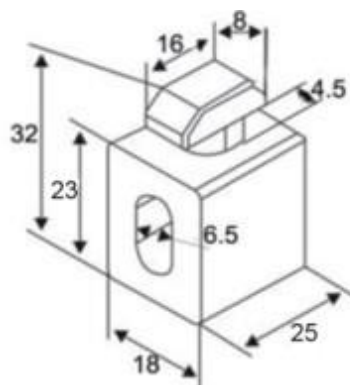

Size	Mass/g	Part No
4040	11	40414

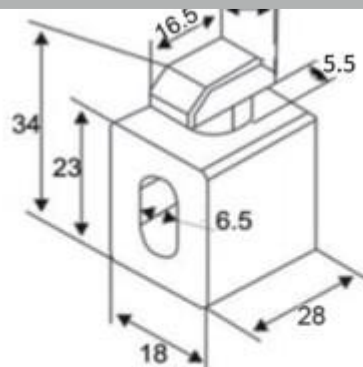

Size	Mass/g	Part No
4545	11.2	45454

Cover

Cover

Material: Plastic

Color : Grey/ Black

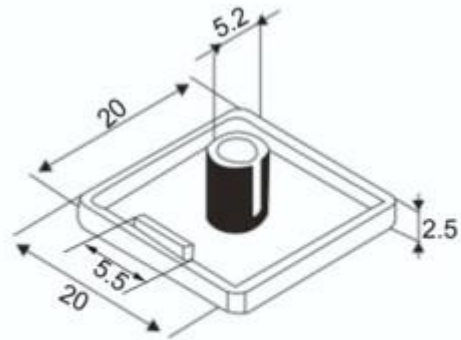

Size	Mass/g	Part No
2020	0.7	20205

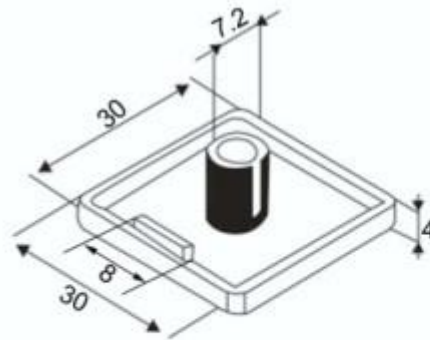

Size	Mass/g	Part No
3030	2.6	30305

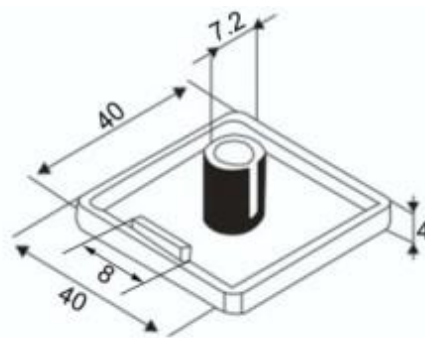

Size	Mass/g	Part No
4040	4.1	40405

Cover

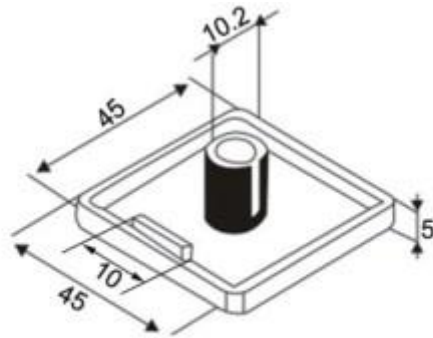

Size	Mass/g	Part No
4545	5.3	45455

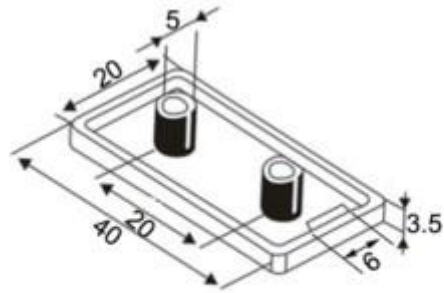

Size	Mass/g	Part No
2040	2	20405

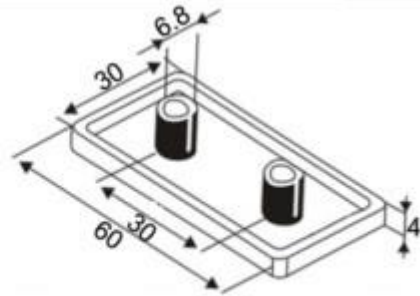

Size	Mass/g	Part No
3060	5	30605

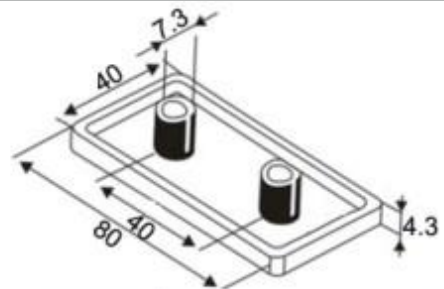

Size	Mass/g	Part No
4080	9.2	40805

Cover

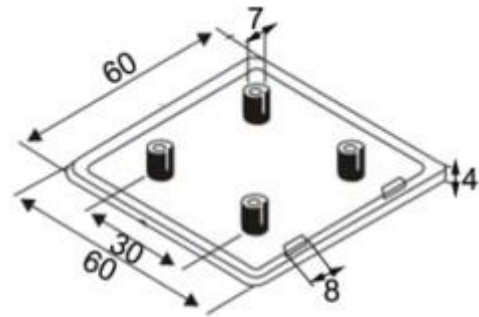

Size	Mass/g	Part No
6060	11.1	60605

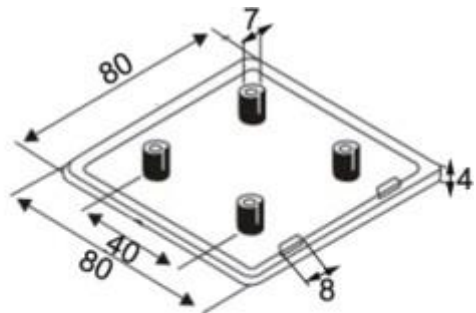

Size	Mass/g	Part No
8080	19.8	80805

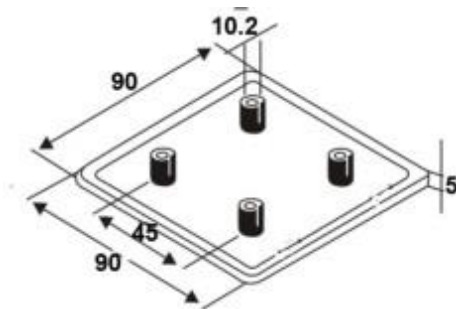

Size	Mass/g	Part No
9090	26	90905

Cover

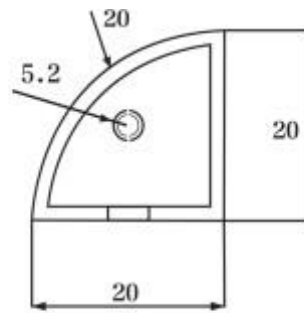

Size	Mass/g	Part No
R2020	1.2	20215

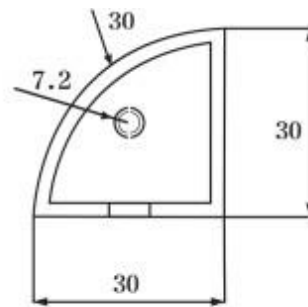

Size	Mass/g	Part No
R3030	3.2	30315

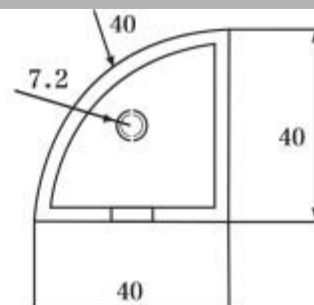

Size	Mass/g	Part No
R4040	5.1	40415

Hinges

Plastic Hinge
Material : Plastic
Color : Black

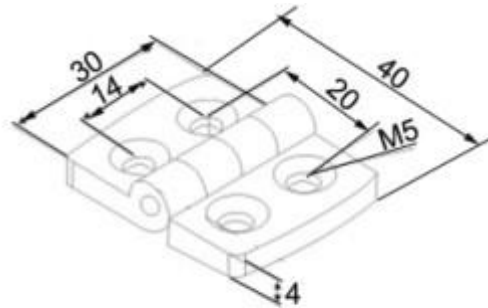

Size	Mass/g	Part No
2020	7.3	20206

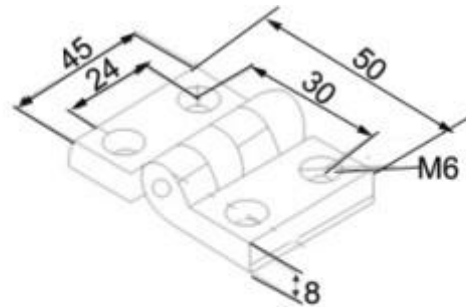

Size	Mass/g	Part No
3030	28	30306

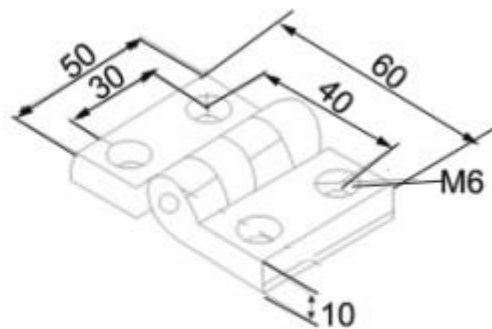

Size	Mass/g	Part No
4040	39.4	40406

Hinges

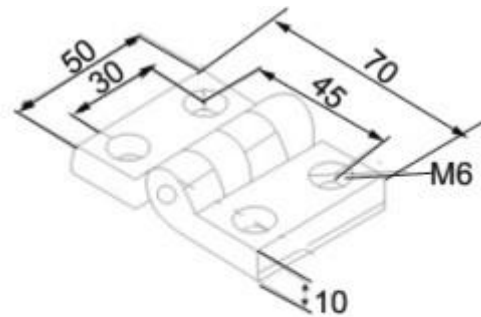

Size	Mass/g	Part No
4545	51	45456

Zinc Hinge
 Material : Zinc alloy
 Color : Silver / Black

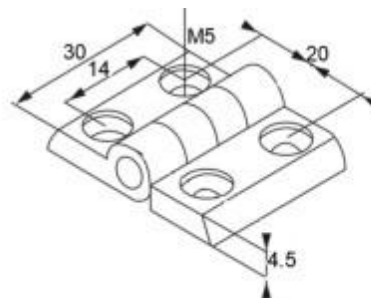

Size	Mass/g	Part No
2020	38	20207

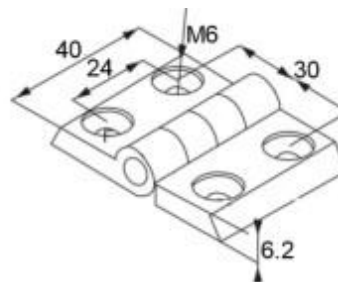

Size	Mass/g	Part No
3030	69	30307

Hinges

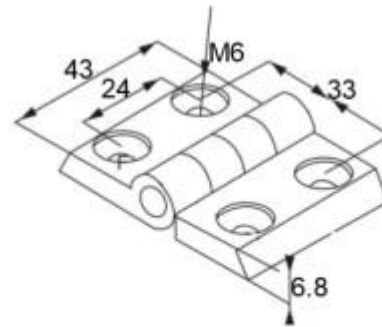

Size	Mass/g	Part No
3040	76	30407

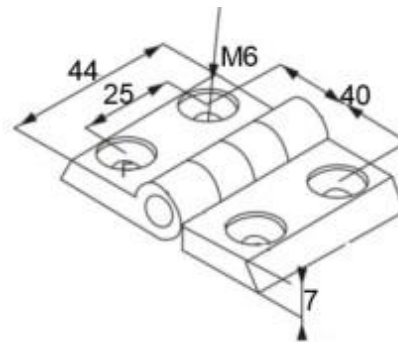

Size	Mass/g	Part No
4040	96	40407

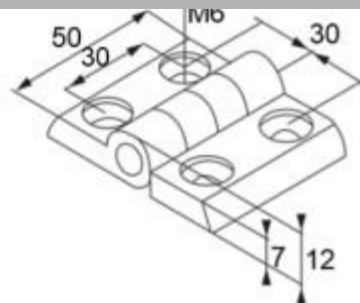

Size	Mass/g	Part No
3030	76	30317

Hinges

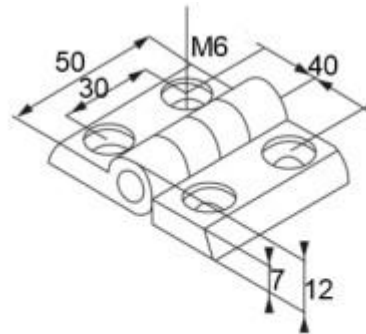

Size	Mass/g	Part No
4040	86	40417

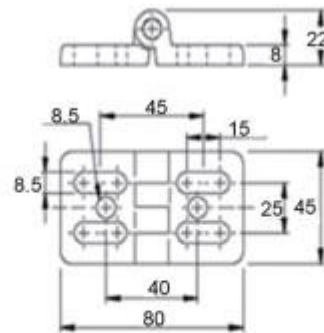

Size	Mass/g	Part No
4545	143	45457

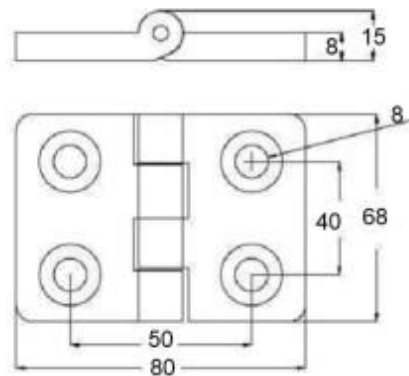

Size	Mass/g	Part No
5050	222	45417

Hinges

T-Slot Bar

Material : Carbon steel

Surface treatment : Zinc plated

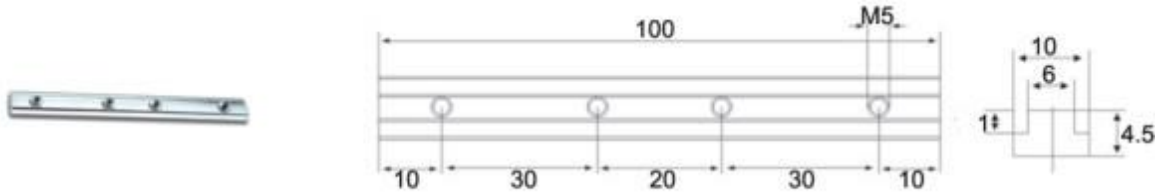

Size	Mass/g	Part No
2020	23	20208

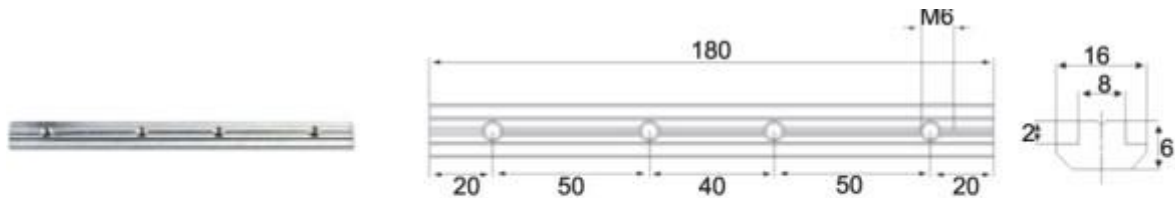

Size	Mass/g	Part No
3030	99	30308

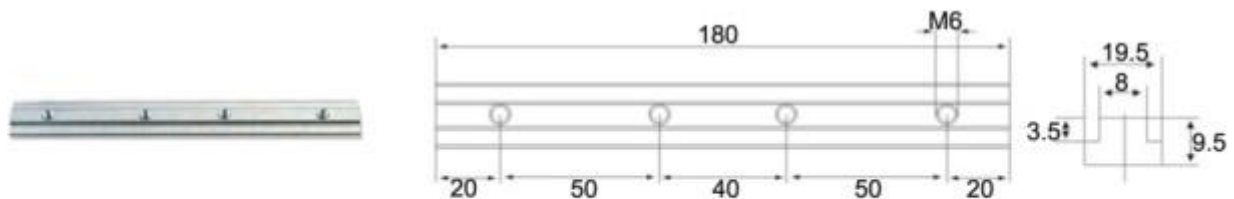

Size	Mass/g	Part No
4040	172	40408

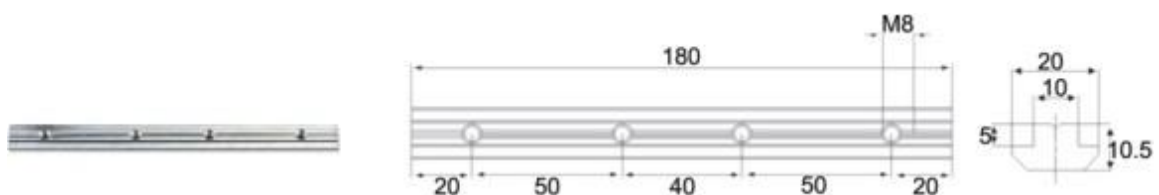

Size	Mass/g	Part No
4545	194	45458

Hinges

T-Slot Bar

Material : Carbon steel

Surface treatment : Zinc plated

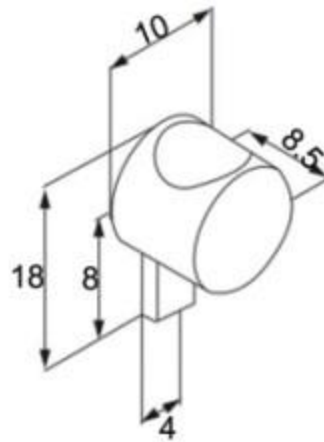

Size	Mass/g	Part No
2020	5.7	20209

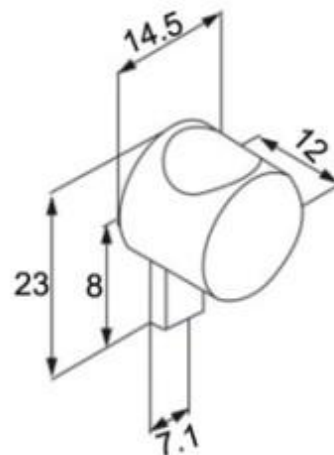

Size	Mass/g	Part No
3030	6.8	30309

Hinges

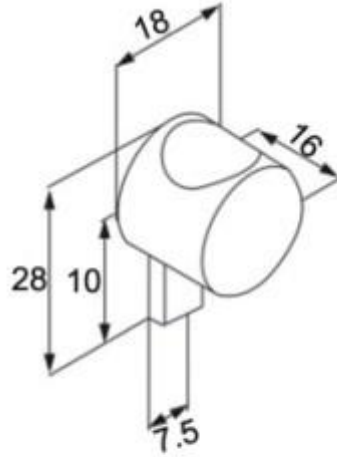

Size	Mass/g	Part No
4040	14.1	40409

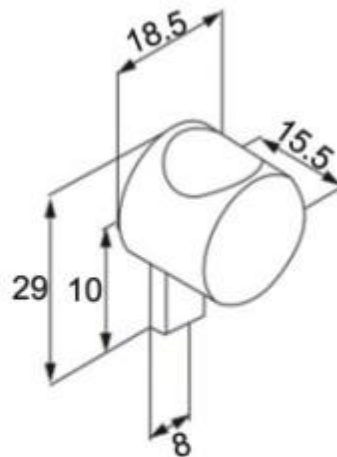

Size	Mass/g	Part No
4545	14.9	45459

Hinges

Handel

Material : Plastic / Zinc alloy

Color : Black / Silver

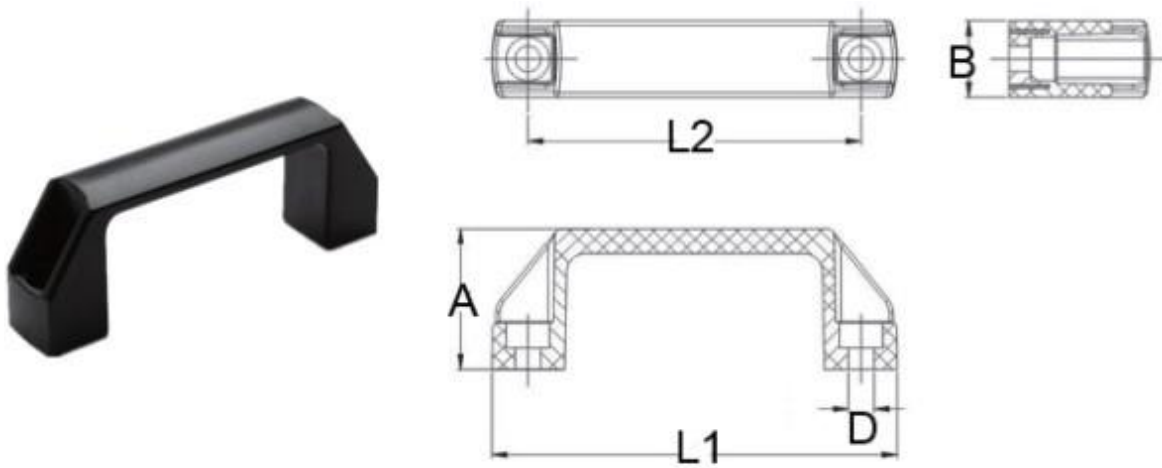

Size	A	B	L1	L2	D	Mass/g	Part No
90	37	20	109	90	6.5	26.3	45690
120	41	25	138	120	8.5	40.1	45691
150	44	28	170	150	8.5	72	45692
160	49	28	185	160	8.5	86	45693
180	52	28	200	180	8.5	94.3	45694

Hinges

Profile Hanger

Material : Steel & plastic

Color : Silver & Black

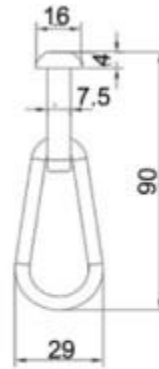
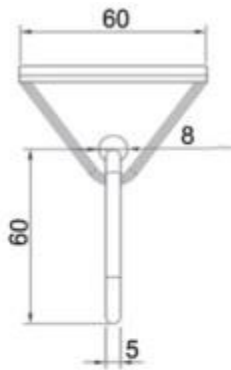

Size	Mass/g	Part No
3030/4040	18.6	45730

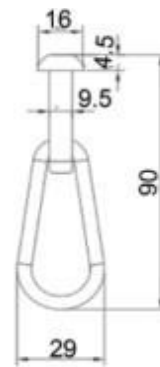
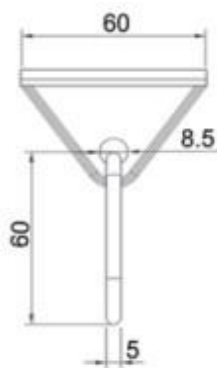

Size	Mass/g	Part No
4545	19.8	45731

3-Way Corner Connector

Material : Zinc alloy
Color : Silver

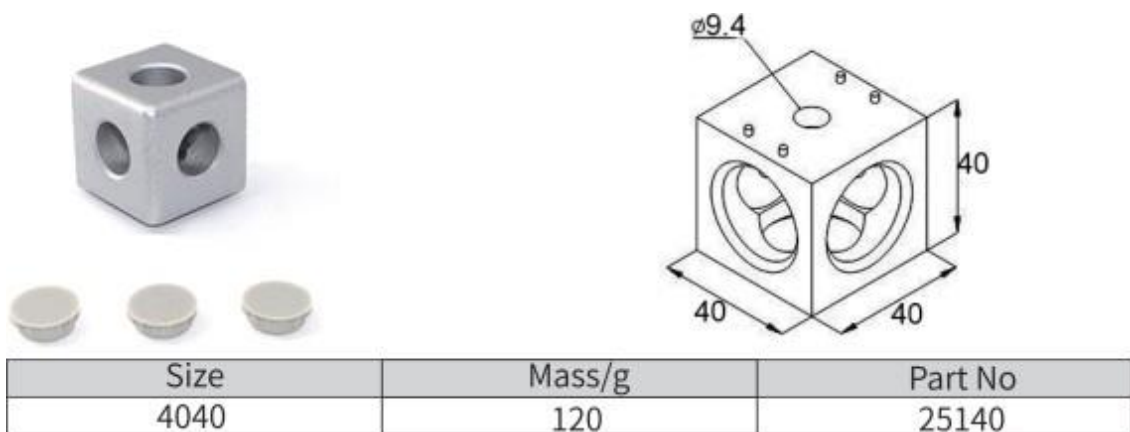
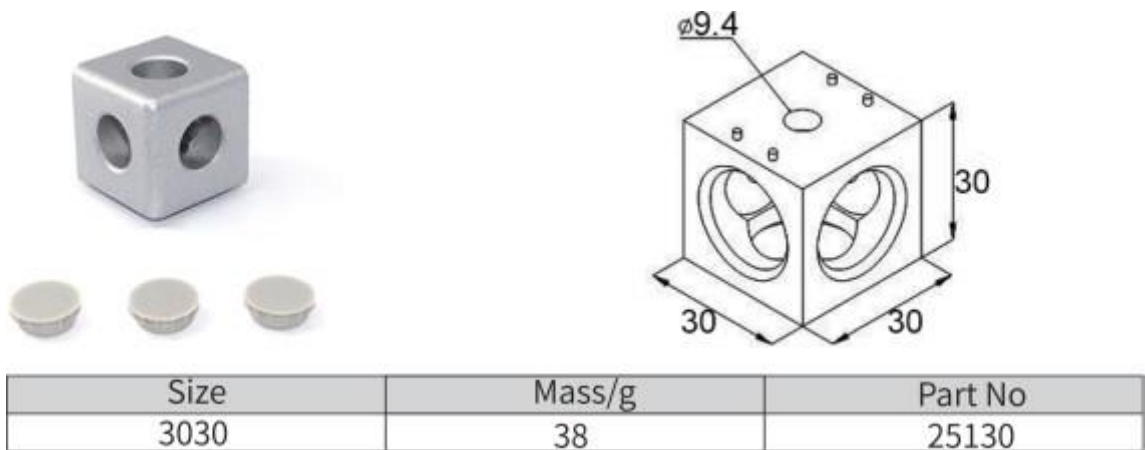
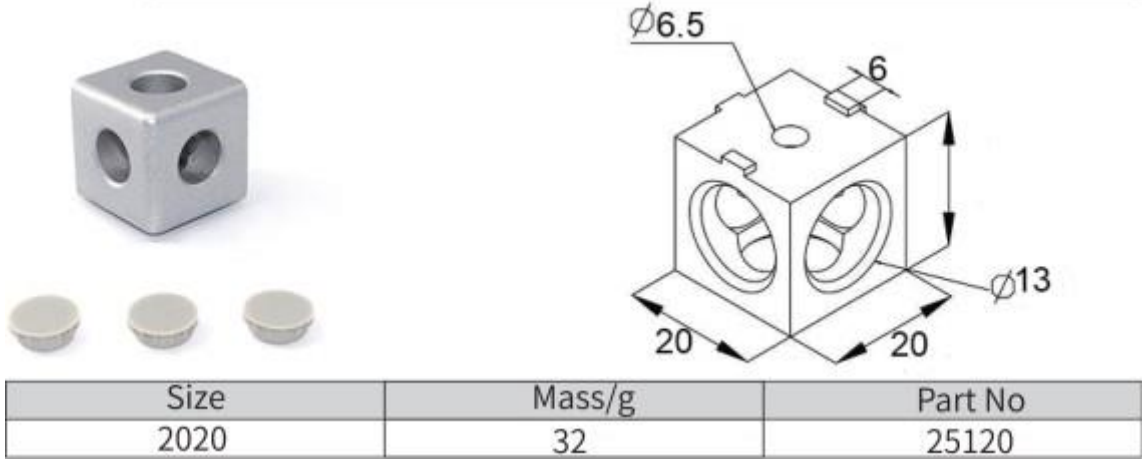

CONNECTOR

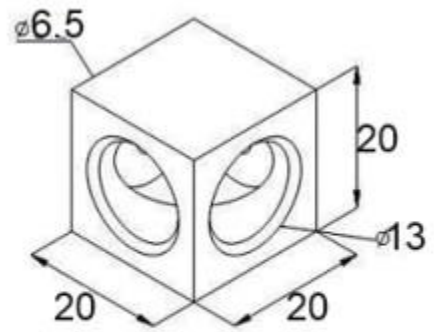

Size	Mass/g	Part No
2020	42	26120

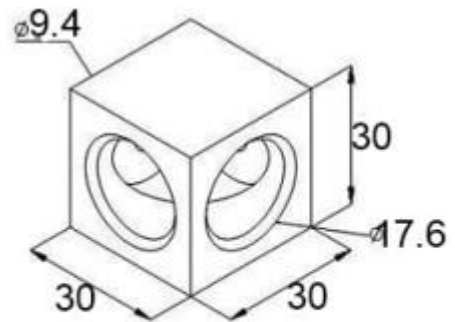

Size	Mass/g	Part No
3030	45	26130

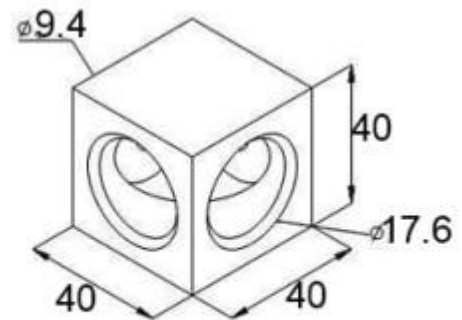

Size	Mass/g	Part No
4040	129	26140

Corner bracket

Concealed 3-way corner bracket

Material : Zinc alloy

Color : Silver

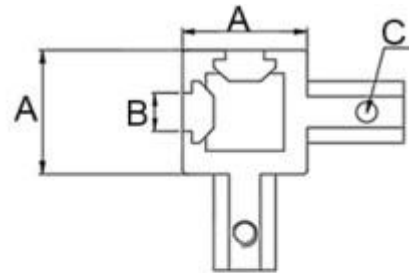

Size	A	B	C	Mass/g	Part No
2020	20	6	4	32	26220
3030	30	8	6	78	26221
4040	40	8	8	181	26222

3-way corner bracket

Material : Zinc alloy / End caps Nylon

Color : Silver

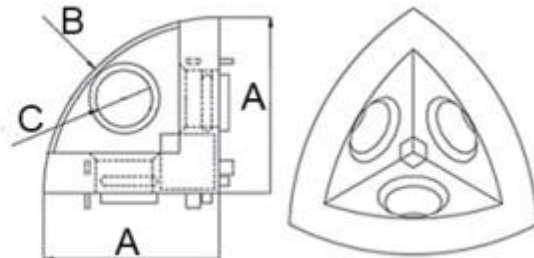
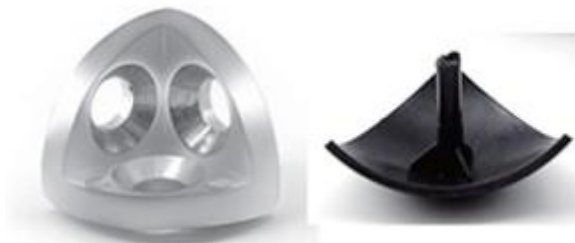

Size	A	B	C	Mass/g	Part No
2020	18.5	20	6	15	26231
3030	28.5	30	9	49	26232
4040	38.5	40	9	112	26233
4545	43.5	45	12.5	133	26234

Flange nuts

3 Flange nuts

Material : Carbon steel / Stainless steel

Surface treatment : Nickel plated / Zinc plated

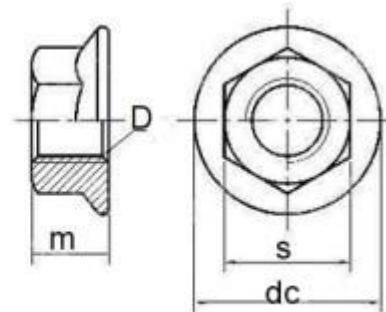

Size	Thread Pitch	m	s	dc	Mass/g	Part No
M3	0.5	3.7	5.3	7.8	0.8	29103
M4	0.7	4.4	6.9	9.2	1.0	29104
M5	0.8	4.8	7.8	10.5	1.2	29105
M6	1.0	5.4	9.8	12.7	2.9	29106
M8	1.25	7.0	12.7	17.0	5.9	29108
M10	1.5	8.4	13.8	18.7	8.0	29110
M12	1.75	10.7	17.8	23.4	12.1	29112

Spring washer

Material : Stainless steel

Surface treatment : Natural

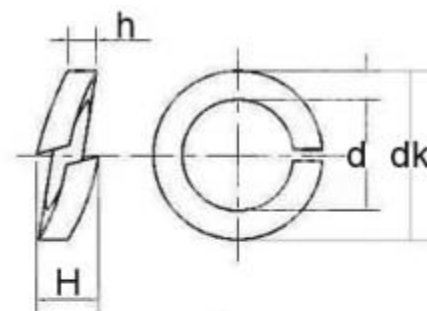

Size	h	H	d	dk	Mass/g	Part No
M3	0.8	1.92	3.3	5.1	0.2	31003
M4	1.1	2.52	4.2	6.4	0.3	31004
M5	1.3	2.83	5.3	8.0	0.5	31005
M6	1.6	3.81	6.5	9.8	0.7	31006
M8	2.1	4.63	8.3	13	0.92	31008
M10	2.5	5.82	10.5	15	1.1	31010
M12	3.1	6.92	12.5	18	1.4	31012

3 Flange nuts

3 Flange nuts

Material : Carbon steel / Stainless steel

Surface treatment : Nickel plated / Zinc plated

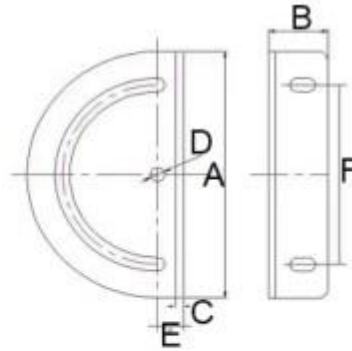

Size	A	B	C	D	E	F	Mass/g	Part No
3030	110	25	3	6	10	80	140	51130
4040	130	30	3	8	17.5	100	204	51140

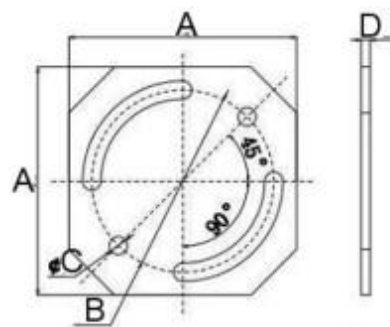

Size	A	B	C	D	Mass/g	Part No
3030	75	60	6	2.8	89	51141
4040	86	65	8	2.8	112	51142

Cross Joining Plate

Cross Joining Plate

Material : Nickel-Plated Carbon Steel

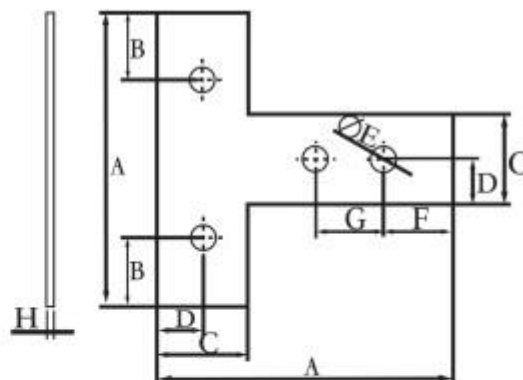

Size	A	B	C	D	E	F	G	H	Mass/g	Part No
2020	55	7.8	17	8.5	6	7.8	20	2	18.6	53120
3030	85	15	26	13	6.5	20	20	2	47.1	53130
4040	110	25	36	18	9	25	25	2	82	53140
4545	140	30	41	20.5	9	30	35	2	108	53145

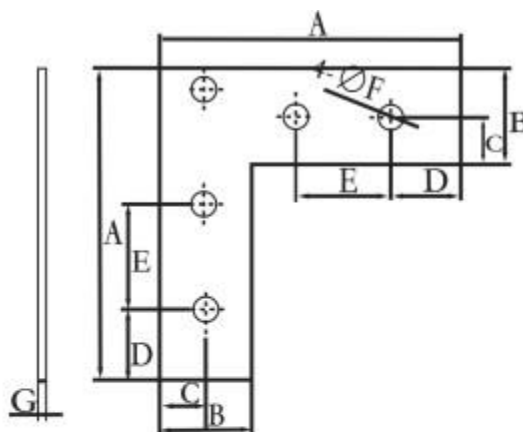

Size	A	B	C	D	E	F	G	Mass/g	Part No
2020	55	17	8.5	8	20	6	2	16.8	53220
3030	85	26	13	20	20	6.5	2	45	53230
4040	110	36	18	25	35	9	2	82	53240
4545	120	41	20.5	30	35	9	2	108	53245

Flat Head Socket Screw

Flat Head Socket Screw

Material : Stainless steel / Steel

Surface Treatment : Natural / Nickel Plated / Black

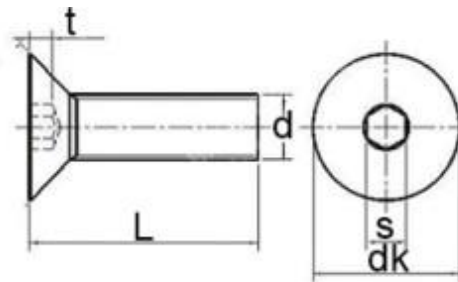

Size	t	d	dk	s	L	Mass/g	Part No
M5	3	5	10	3	6	4.6	34106
					8	4.9	34108
					10	5.3	34110
					12	5.7	34112
					16	6.2	34116
					20	7.1	34120
					25	8	34125
					30	8.6	34130
M6	4	6	12	4	8	6.2	34208
					10	7.1	34210
					12	8	34212
					16	8.6	34216
					20	9.2	34220
					25	10.2	34225
					30	12.5	34230
					35	13.7	34235
M8	5	8	16	5	10	8.2	34310
					12	8.6	34312
					16	9.2	34316
					20	10.2	34320
					25	12.5	34325
					30	13.7	34330
					35	15.2	34335
					40	15.9	34340
					45	16.4	34345
					50	17.8	34350
55	18.9	34355					

Adjustable Leveling Foot

Adjustable Leveling Foot

Material : Nickel - Plated Carbon Steel

Stainless Steel stud with Nylon Base

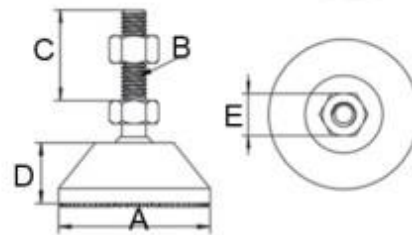

Size	A(Φ)	B	C	D	E(Φ)	Max Load/kg	Mass/g	Part No		
40-M6×50	40	M6	50	20	12	50	68	41650		
40-M8×50			50				85	41850		
40-M8×80		M8	80		14	60	89	41880		
40-M8×100			100				92	41100		
40-M10×50		M10	50		14	70	92	42150		
40-M10×80			80				104	42180		
40-M10×100			100				112	42100		
40-M12×50			M12				50	17	90	122
40-M12×100		100			149	43100				
50-M8×50		50	M8		50	20	14	60	79	44150
50-M8×100	100			83	44100					
50-M10×50	M10		50	14	70		90	44550		
50-M10×80			80				105	44580		
50-M12×50	M12		50	17	90		106	44250		
50-M12×80			80				127	44280		
50-M12×100			100				142	44290		
60-M12×50			M12				50	24	17	130
60-M12×80	80			130	45080					
60-M12×100	100			157	45100					
60-M16×50	M16	50		22	150	132	46150			
60-M16×80		80				138	46180			
60-M16×100		100				176	46100			
60-M16×150		150	189			46190				
80-M16×50	80	M16	50	25	22	200	209	47060		
80-M16×80			80				234	47080		
80-M16×100			100				263	47100		
80-M16×150			150				284	47150		
80-M20×100	80	M20	100	25	24	220	346	47110		
80-M20×150			150				362	47180		
80-M24×100	80	M24	100	25	30	240	496	47190		
80-M24×150			150				513	47191		
100-M16×100	100	M16	100	30	22	220	324	48100		
100-M16×150			150				349	48150		
100-M20×100		M20	100		24	240	447	48200		
100-M20×150			150				497	48250		
100-M24×100		M24	100		30	260	642	48410		
100-M24×150			150				669	48420		
80-M8×50		80	M8		50	20	15	150	109	48421
80-M8×80					80				129	48422

Flat Head Socket Screw

Flat Head Socket Screw

Material: Stainless steel / Steel

Surface Treatment: Natural / Nickel Plated / Black

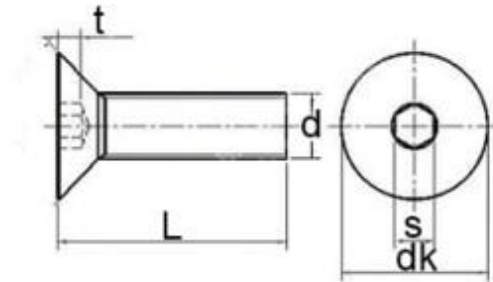

Size	t	d	dk	s	L	Mass/g	Part No
M5	3	5	10	3	6	4.6	34106
					8	4.9	34108
					10	5.3	34110
					12	5.7	34112
					16	6.2	34116
					20	7.1	34120
					25	8	34125
					30	8.6	34130
M6	4	6	12	4	8	6.2	34208
					10	7.1	34210
					12	8	34212
					16	8.6	34216
					20	9.2	34220
					25	10.2	34225
					30	12.5	34230
					35	13.7	34235
M8	5	8	16	5	10	8.2	34310
					12	8.6	34312
					16	9.2	34316
					20	10.2	34320
					25	12.5	34325
					30	13.7	34330
					35	15.2	34335
					40	15.9	34340
					45	16.4	34345
					50	17.8	34350
55	18.9	34355					

Adjustable Leveling

Adjustable Leveling Foot

Material: Nickel - Plated Carbon Steel

Stainless Steel Stud with Nylon Base

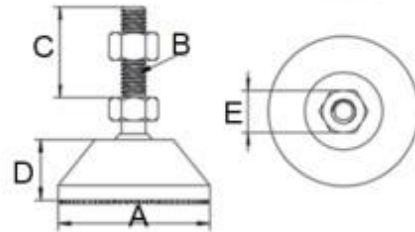

Size	A(Φ)	B	C	D	E(Φ)	Max Load/kg	Mass/g	Part No			
40-M6×50	40	M6	50	20	12	50	68	41650			
40-M8×50			50				85	41850			
40-M8×80			80				89	41880			
40-M8×100		M8	100		92	41100					
40-M10×50			M10		50	92	42150				
40-M10×80					80	104	42180				
40-M10×100					100	112	42100				
40-M12×50		M12	50		122	43050					
40-M12×100			100		149	43100					
50-M8×50			50		M8	50	20	14	60	79	44150
50-M8×100	100	83		44100							
50-M10×50	M10	50		90		44550					
50-M10×80		80		105	44580						
50-M12×50		M12		50	106	44250					
50-M12×80				80	127	44280					
50-M12×100	100			142	44290						
60-M12×50	60	M12		50	24	17		130	121	45050	
60-M12×80				80				130	45080		
60-M12×100				100				157	45100		
60-M16×50		M16	50	132		46150					
60-M16×80			80	138		46180					
60-M16×100			100	176		46100					
60-M16×150			150	189		46190					
80-M16×50			80	M16		50	25	22	200	209	47060
80-M16×80						80			234	47080	
80-M16×100						100			263	47100	
80-M16×150	150	284			47150						
80-M20×100	80	M20			100	25			24	220	346
80-M20×150			150	362	47180						
80-M24×100	80	M24	100	25	30	240	496	47190			
80-M24×150			150				513	47191			
100-M16×100			100				M16	100	30	22	220
100-M16×150	150	349		48150							
100-M20×100	M20	100		24	240	447		48200			
100-M20×150		150		497	48250						
100-M24×100		M24		100	30	260	642	48410			
100-M24×150				150			669	48420			
80-M8×50	80	M8		50	20	15	150	109		48421	
80-M8×80				80				129		48422	

Fixed Leveling Foot

Fixed Leveling Foot

Material: Material Nickel

Zinc-Plated Carbon Steel Stud with Nylon base

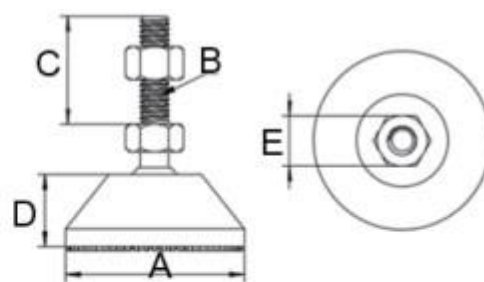

Size	A(Φ)	B	C	D	E(Φ)	Max Load/kg	Mass/g	Part No
F40-M8×50	40	M8	50	25	13	100	57.1	51411
F40-M8×80			80	25			70	51412
F40-M10×50	40	M10	50	25	17	100	76	51413
F40-M10×80			80				92.1	51414
F40-M10×100			100				102	51415
F40-M12×50	40	M12	50	25	19	100	108.4	51416
F40-M12×100			100				113.7	51417
F40-M12×120			120				126	51418
F50-M8×50	50	M8	50	25	13	150	64	51419
F50-M8×80			80	73.6			51420	
F50-M10×50	50	M10	50	25	17	150	84	51421
F50-M10×80			80				99	51422
F50-M12×50	50	M12	50	25	19	150	119	51423
F50-M12×80			80				122	51424
F50-M12×100			100				138	51425
F50-M14×80	60	M14	80	27	22	200	134	51426
F50-M14×100			100				149	51427
F60-M16×100	60	M16	100	27	24	200	152	51428
F60-M16×120			120				168	51429
F60-M16×150			150				173	51430
F80-M16×100	80	M16	100	28	24	250	189	51431
F80-M16×120		M18	120				195	51432
F80-M16×150		M20	150				209	51433
F80-M20×100	100	M18	100	30	30	300	226	51434
F80-M20×120		M20	120				237	51435
F80-M20×150		M24	150				256	51436

T-Slot Tread Strip

T-Slot Tread Strip

Material - Soft Rubber

Color: Black (Slot 4/6/8/10), Blue (Slot 4/6/8/10)

Gray (Slot 4/6/8/10) Silver (Slot 6/8/10)

Green (Slot 6/8), Red (Slot 6/8), Orange (Slot 6/8)



Leveling Caster

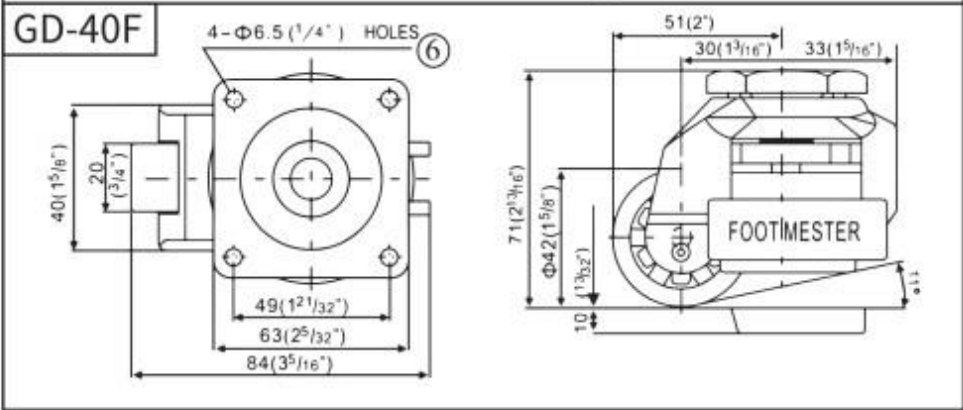
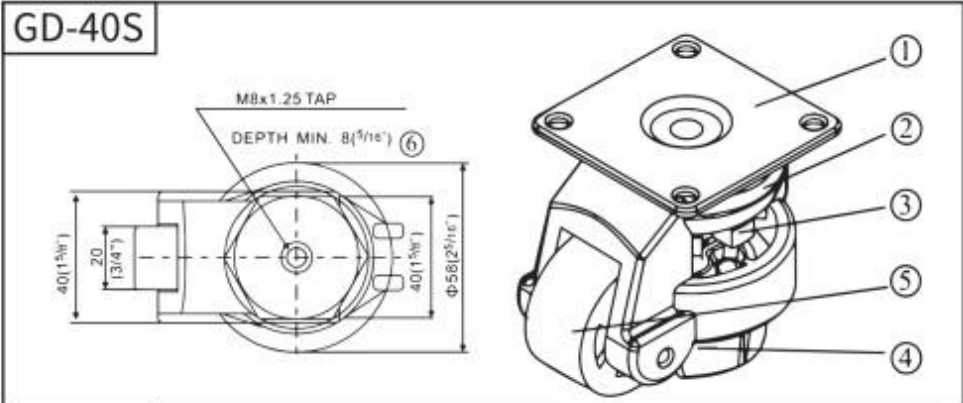

Model	Material :								
	①Carbon steel stamping		②Aluminum alloy		③MC Nylon		④NBR ⑤MC Nylon ⑥Surface treatment : Spraying & Galvanizing		
GD-40S	Recommended load/4pcs	Load capacity/pc	Wheel Diameter	Bolt Size		Overall Height	Adjustable range	Mass/kg	Part No
	100 kg	50 kg	42 mm	M8×10		71 mm	10 mm	0.35	91040
GD-40F	Recommended load/4pcs	Load capacity/pc	Wheel Diameter	Plate Hole Centers	Size of Plate	Overall Height	Adjustable range	Mass/kg	Part No
	100 kg	50 kg	42 mm	49×49	63×63	71 mm	10 mm	0.35	91041

Leveling Caster

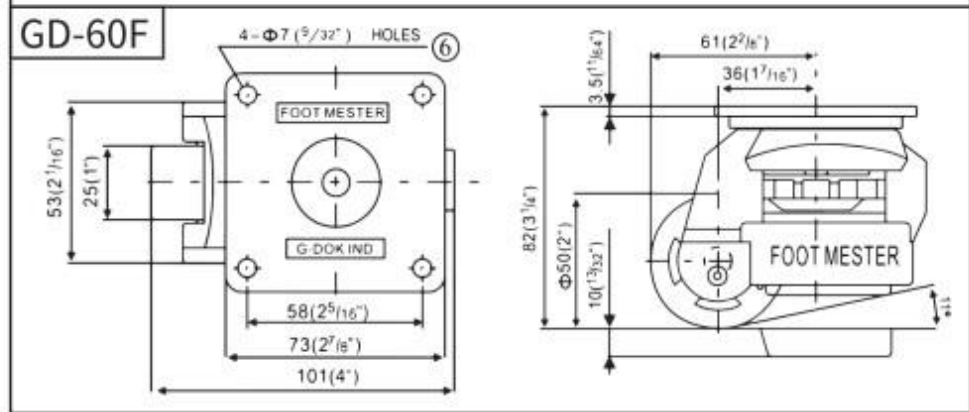
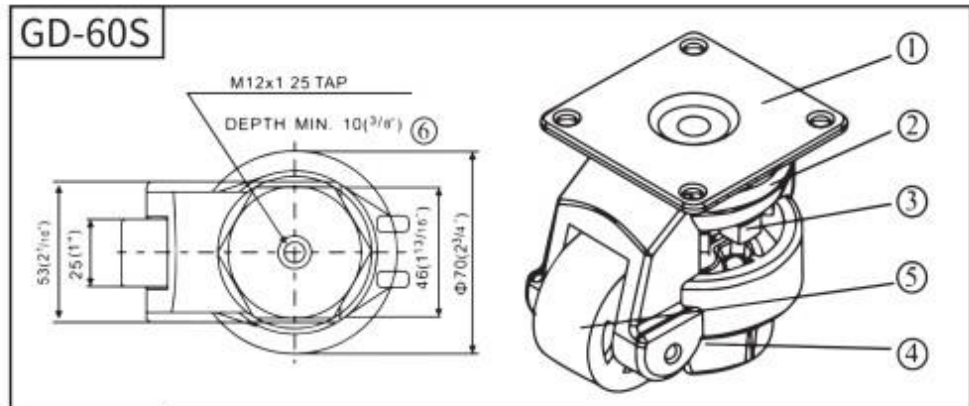

Model	Material :								
	①Carbon steel stamping		②Aluminum alloy		③MC Nylon		④NBR ⑤MC Nylon ⑥Surface treatment : Spraying & Galvanizing		
GD-60S	Recommended load/4pcs	Load capacity/pc	Wheel Diameter	Bolt Size		Overall Height	Adjustable range	Mass/kg	Part No
	500 kg	250 kg	50 mm	M12×15		82 mm	10 mm	0.7	91042
GD-60F	Recommended load/4pcs	Load capacity/pc	Wheel Diameter	Plate Hole Centers	Size of Plate	Overall Height	Adjustable range	Mass/kg	Part No
	500 kg	250 kg	50 mm	58×58	73×73	782mm	10 mm	0.7	91043

Leveling Caster

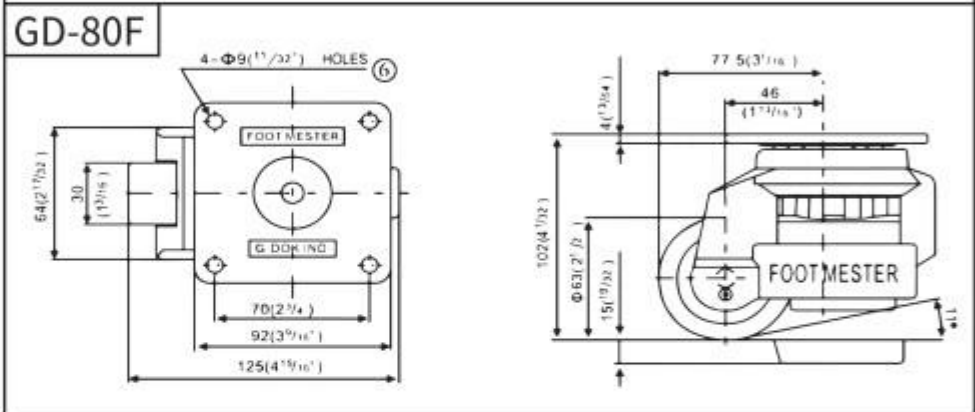
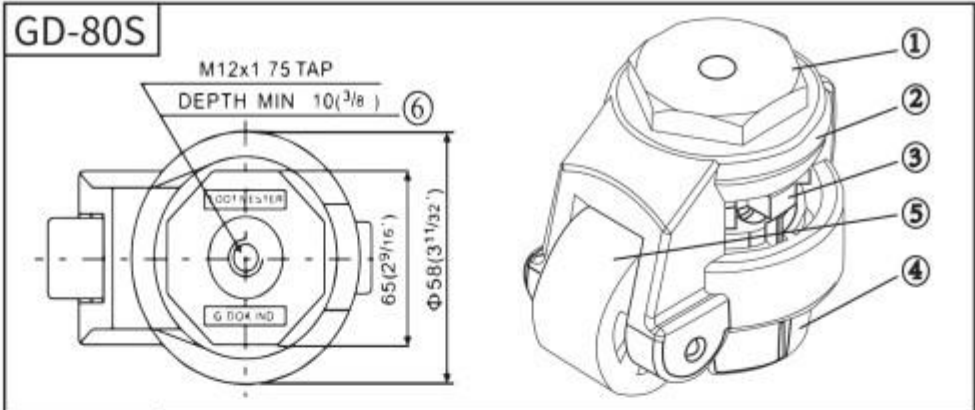

Model	Material :								
	①Carbon steel stamping			②Aluminum alloy			③MC Nylon		
	④NBR		⑤MC Nylon		⑥Surface treatment : Spraying & Galvanizing				
GD-80S	Recommended load/4pcs	Load capacity/pc	Wheel Diameter	Bolt Size		Overall Height	Adjustable range	Mass/kg	Part No
	1000 kg	500 kg	63 mm	M12×15		102 mm	15 mm	1.3	91044
GD-80F	Recommended load/4pcs	Load capacity/pc	Wheel Diameter	Plate Hole Centers	Size of Plate	Overall Height	Adjustable range	Mass/kg	Part No
	1000 kg	500 kg	63 mm	70×70	90×90	102 mm	15 mm	1.3	91045

Leveling Caster

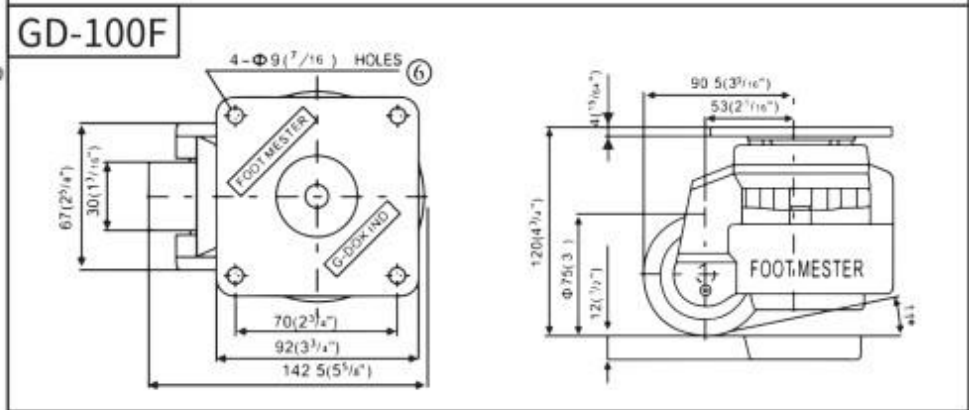
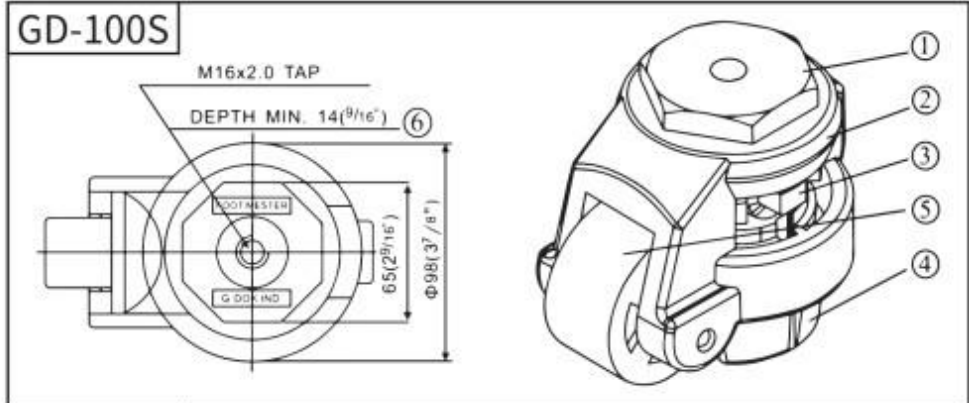

Model	Material :								
	①Carbon steel stamping		②Aluminum alloy		③MC Nylon		④NBR ⑤MC Nylon ⑥Surface treatment : Spraying & Galvanizing		
GD-100S	Recommended load/4pcs	Load capacity/pc	Wheel Diameter	Bolt Size		Overall Height	Adjustable range	Mass/kg	Part No
	1500 kg	750 kg	75 mm	M16×20		120 mm	12 mm	1.75	91046
GD-100F	Recommended load/4pcs	Load capacity/pc	Wheel Diameter	Plate Hole Centers	Size of Plate	Overall Height	Adjustable range	Mass/kg	Part No
	1500 kg	750 kg	75 mm	70×70	92×92	120 mm	12 mm	1.75	91047

Leveling Caster

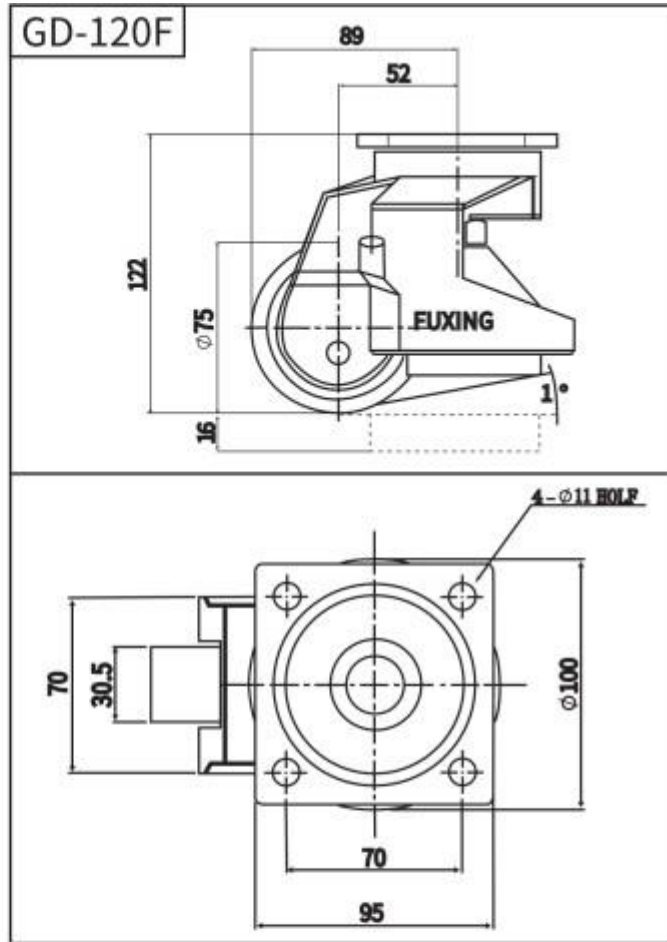

Model	Material :								
	①Carbon steel stamping ②Aluminum alloy ③MC Nylon ④NBR ⑤Surface treatment : Spraying & Galvanizing								
GD-120F	Recommended load/4pcs	Load capacity/pc	Wheel Diameter	Plate Hole Centers	Size of Plate	Overall Height	Adjustable range	Mass/kg	Part No
	2000 kg	1000 kg	75 mm	70×70	95×95	120 mm	12 mm	1.73	91048